

Parts Catalog

**Maytag
Commercial
Dryer**

MDG30MC2A
MDG30PC2A
MDG30PN2A

GENERAL SAFETY PRECAUTIONS

Information contained in this manual is intended for use by a qualified service technician familiar with proper and safe procedures to be followed when repairing an electrical appliance. All tests and repairs should be performed by a qualified service technician equipped with proper tools and measuring devices. All component replacements should be made by a qualified service technician using only factory approved replacement parts.

Improper assembly or adjustment may occur if service or repair is attempted by persons other than qualified service technicians or if parts other than approved replacement parts are used. Improper assembly or adjustment can create hazardous conditions.

There can be risk of injury or electrical shock while performing services or repairs. Injury or electrical shock can be serious or even fatal. Consequently, extreme caution should be taken when performing voltage checks on individual components of a product. Except as necessary to perform a particular step in servicing a product, the electrical power supply should **ALWAYS** be disconnected when servicing a product.

Further, this appliance **MUST** be properly grounded. Never plug in or direct wire an appliance unless it is properly grounded and in accordance with all local and national codes. See installation instructions that accompany the product for grounding this appliance.

CONTENTS

SECTION	PAGE
<u>CONTROL PANEL ASSEMBLY (OPL, COIN)</u>	<u>2-3</u>
<u>CONTROL PANEL ASSEMBLY (COIN METER)</u>	<u>4</u>
<u>COIN METER</u>	<u>5</u>
<u>CONTROL BOX ASSEMBLY (MICROPROCESSOR)</u>	<u>6</u>
<u>CONTROL BOX ASSEMBLY (NON-COMPUTER)</u>	<u>7</u>
<u>COIN VAULT</u>	<u>8</u>
<u>ELECTRICAL RELAY PANEL</u>	<u>9</u>
<u>CABINET (CONTROL, FRONT, LINT DOORS)</u>	<u>10-13</u>
<u>DOOR ASSEMBLY</u>	<u>14</u>
<u>MAIN DOOR SWITCH</u>	<u>15</u>
<u>LINT TRAP ASSEMBLY</u>	<u>16</u>
<u>TUMBLER & SUPPORT ASSEMBLY</u>	<u>17</u>
<u>SENSOR BRACKET ASSEMBLY</u>	<u>18-19</u>
<u>IDLER BEARING ASSEMBLY</u>	<u>20-21</u>
<u>TUMBLER BEARING ASSEMBLY</u>	<u>22-23</u>
<u>MOTOR & MOUNT ASSEMBLY</u>	<u>24-25</u>
<u>DIRECT SPARK IGNITION ASSEMBLY</u>	<u>26-27</u>
<u>SAIL SWITCH/HI LIMIT ASSEMBLY</u>	<u>28</u>

NOTE: This Parts Catalog, P/N 16000225, contains parts for the following Multi-Dryer models:

MDG30MC2A(*)

MDG30PC2A(*)

MDG30PN2A(*)

Models:

MDG30PN2A(*)

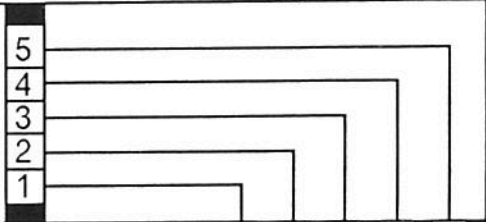

NO.	PART NUMBER	DESCRIPTION	#SEE BELOW					
				1	2	3	4	5
-	801206	Phase 5 OPL Non-Reversing Microprocessor Control Panel Assy. Complete	1					
1	112535	OPL English Keyboard Label Assy.	1					
	112276	OPL Stick-on Labels (English Only)(Not Illstr.)	1					
	112277	OPL Stick-on Labels (English, Spanish, Hebrew)	1					
2	801255	Phase 5 Microprocessor Control Panel	1					
	801256	Phase 5 Micro. Cntrl. Pnl. W/Battery Brkt.	1					
3	137222	Phase 5 OPL Non-Reversing Controller	1					
	824998	Phase 5 Battery Clip	1					
4	153010	Star Washer (#6)	2					
5	150005	Machine Screw (#6-32 x 1/4" PH. Rnd. HD.)	2					
6	160005	Latch, Spring Turn (2-Piece)	1					

IMPORTANT: Check Label On Computer Chip To Verify Correct Part Number Of Controller.

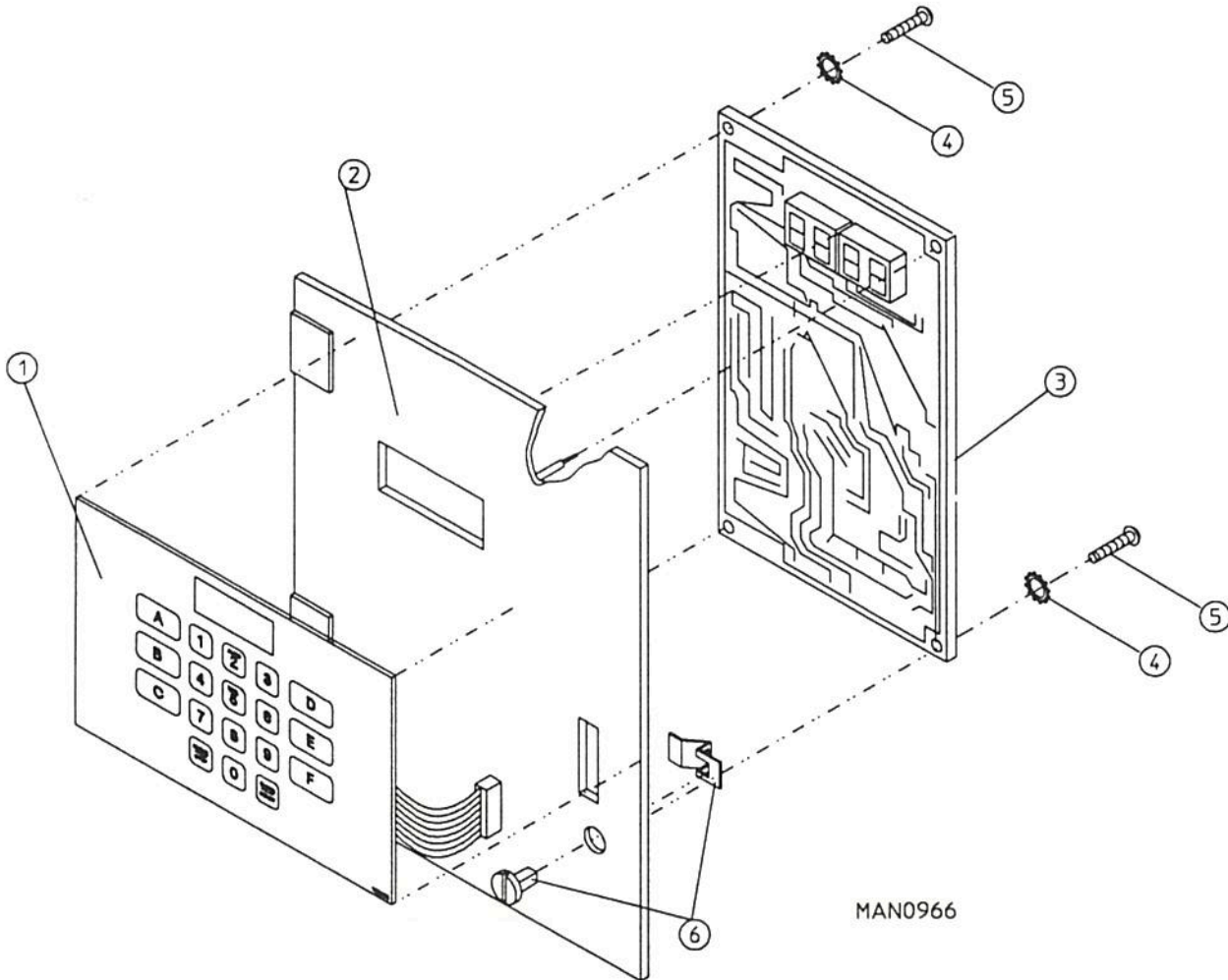

Models:

MDG30PC2A(*)

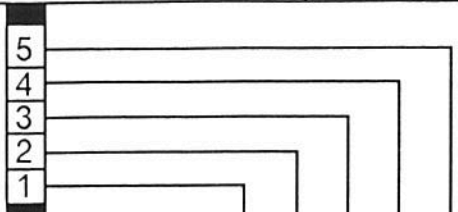

NO.	PART NUMBER	DESCRIPTION	#SEE BELOW	1	2	3	4	5
-	801213	Phase 5 Coin Control Panel Assy. (Incls. Ills. #1, 2, 4, 5, & 6)		1				
-	801229	Phase 5 Coin Control Panel Assy. With Battery Opt. (Incls. Ills. #1, 2, 4, 5, & 6)		1				
1	112526	Coin Keyboard Label Assy.		1				
2	801259	Coin Control Panel		1				
	801258	Coin Control Panel W/Battery Bracket		1				
3	150415	Crimptite Screw (#10-16 x 1/2" PH RND HD)		1				
4	137213	Phase 5 Coin Controller Only		1				
	824998	Phase 5 Battery Clip		1				
5	153010	Star Washer (#6)		2				
6	150005	Machine Screw (#6-32 1/4" PH RND HD)		2				
7	125100	Microprocessor Coin Acceptor 25¢ With Optical Switch		1				
8	137056	Optic Switch Only		1				
9	137023	Optic Switch Connector Only		1				
10	137021	Microprocessor Socket Only		3				
	880772	Single Coin Optical Switch Harness		1				
-	122800	Microprocessor (Female) Pin Extraction Tool		1				

IMPORTANT: Check Label On Computer Chip To Verify Correct Part Number Of Controller.

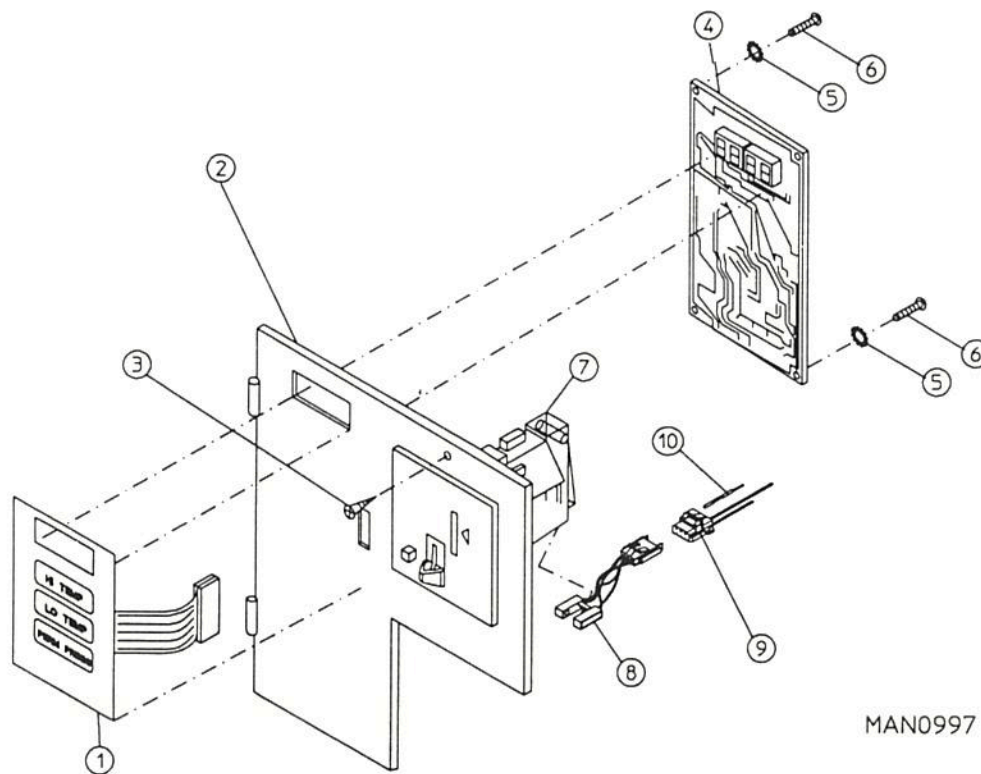

MAN0997

10/92	*COLOR CODE	(-)=NOT SHOWN	#=SERIES, SER PRE OR RUN NO.	MTLA68
-------	-------------	---------------	------------------------------	--------

Models:

MDG30MC2A(*)

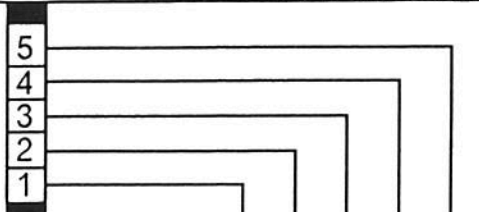

NO.	PART NUMBER	DESCRIPTION	#SEE BELOW	1	2	3	4	5
1	123005	Red Indicator Light (24v)	1					
2	122400	Rocker Heat Selector Switch	1					
3	824020	Coin Meter Control Panel Assy. Comp. 24v (Incls. Ills. #1 - 6 & 8 - 12)	1					
	800054	Coin Meter Control Panel Only	1					
4	131917	Push-To-Start Relay (24v)	1					
5	150207	Machine Screw (#10-24 x 1/2" Rnd. Head)	2					
6	154001	Speed Nut (#10-24)	2					
7	125601	25¢ Coin Meter 24v (Specify Timing)	1					
8	150303	Screw (#4 x 3/4" Pan Head "A")	2					
9	120712	Terminal Block (12-Position)	1					
10	160005	Spring Turn Latch (2-Piece)	1					
11	122602	Connector Only (9-Pin)	1					
12	122700	Pin Terminal Only	9					
-	122801	Pin/Socket Extraction Tool	1					

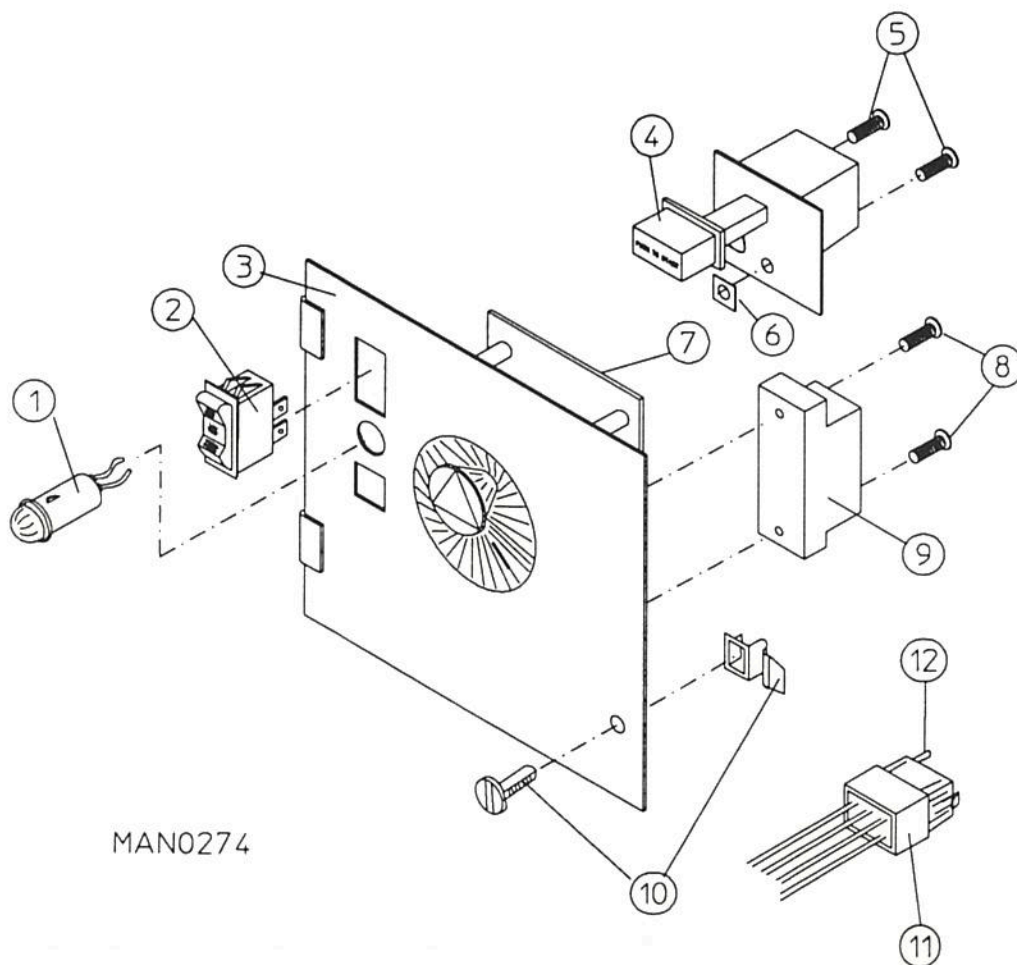

MAN0274

10/92	*COLOR CODE	(-)=NOT SHOWN	#=SERIES, SER PRE OR RUN NO.	MTLA69
-------	-------------	---------------	------------------------------	--------

Models:

MDG30MC2A(*)

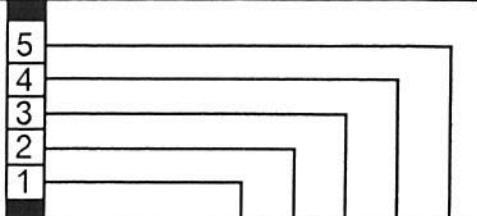

NO.	PART NUMBER	DESCRIPTION	#SEE BELOW	1	2	3	4	5
1	125541	1/60 RPM 24v/60Hz Meter Motor		1				
2	125500	2-Point Cam		1				
	125501	3-Point Cam		1				
	125502	4-Point Cam		1				
	125503	5-Point Cam		1				
	125504	6-Point Cam		1				
	125506	8-Point Cam		1				
	125507	9-Point Cam		1				
	125508	10-Point Cam		1				
	125510	12-Point Cam		1				
3	125515	Meter Switch "B" With Arm		1				
4	125516	Meter Switch "A" Or "C"		2				

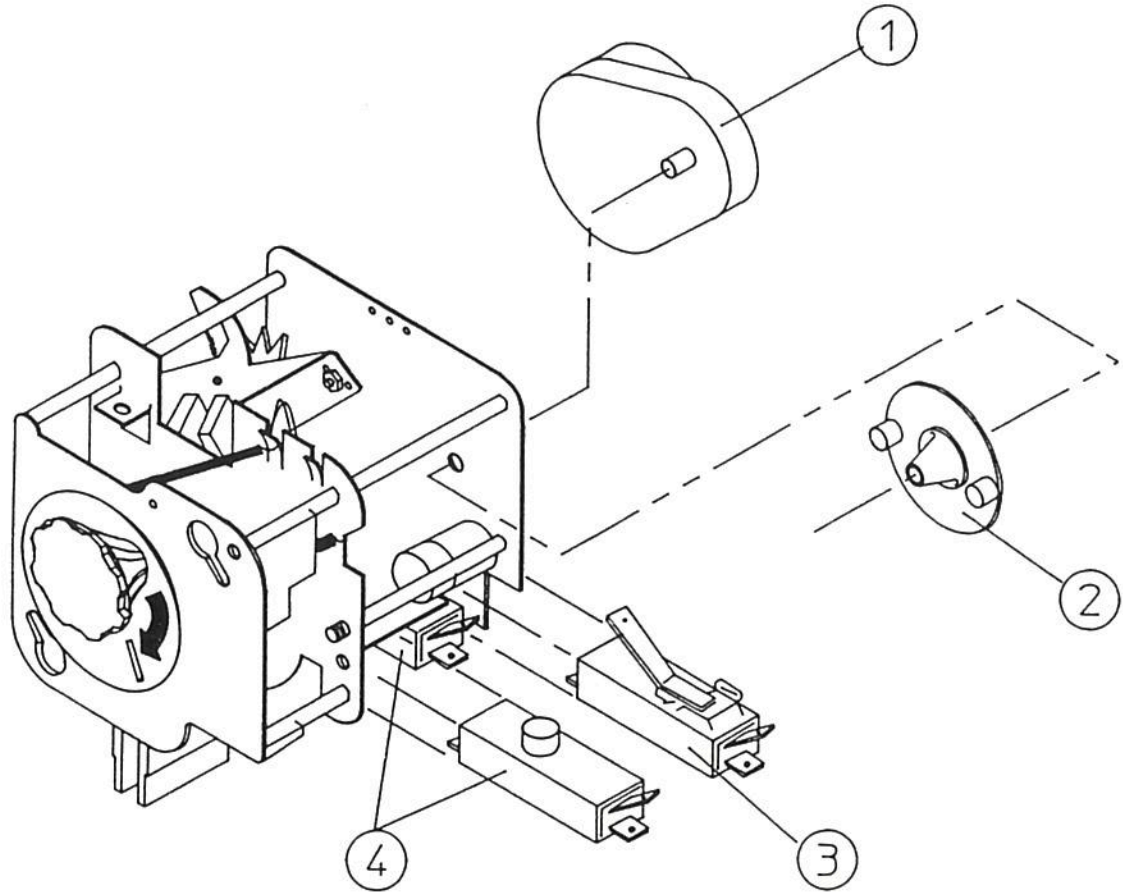

MAN0001

10/92	*COLOR CODE	(-)=NOT SHOWN	#=SERIES, SER PRE OR RUN NO.	MTLA70
-------	-------------	---------------	------------------------------	--------

Models:

MDG30PN2A(*)
MDG30PC2A(*)

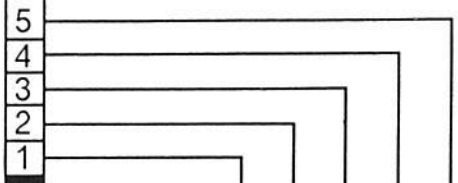

NO.	PART NUMBER	DESCRIPTION	#SEE BELOW	1	2	3	4	5
1	141403	Transformer, DSI 24VAC		1	1			
2	150300	Tek Screw (#10 x 1/2", Hex Washer)		2	2			
3	120715	Block, Terminal (30-Position)		1	1			
4	150002	Screw (#6-32 x 1", Slotted Rnd. Hd.)		2	2			
5	151000	Pal Nut (#6-32)		2	2			
6	136057	Fuse, 1/2-Amp (Slo Blo)(As Required)		-	-			
7	150301	Screw (#8 x 7/16", Self-Drilling)(As Required)		-	-			
8	136008	Strip, Fuse Block (As Required)		-	-			
9	122641	Connector, 15 Pin Micro Processor		1	1			
10	122706	Sockets (As Required)		-	-			

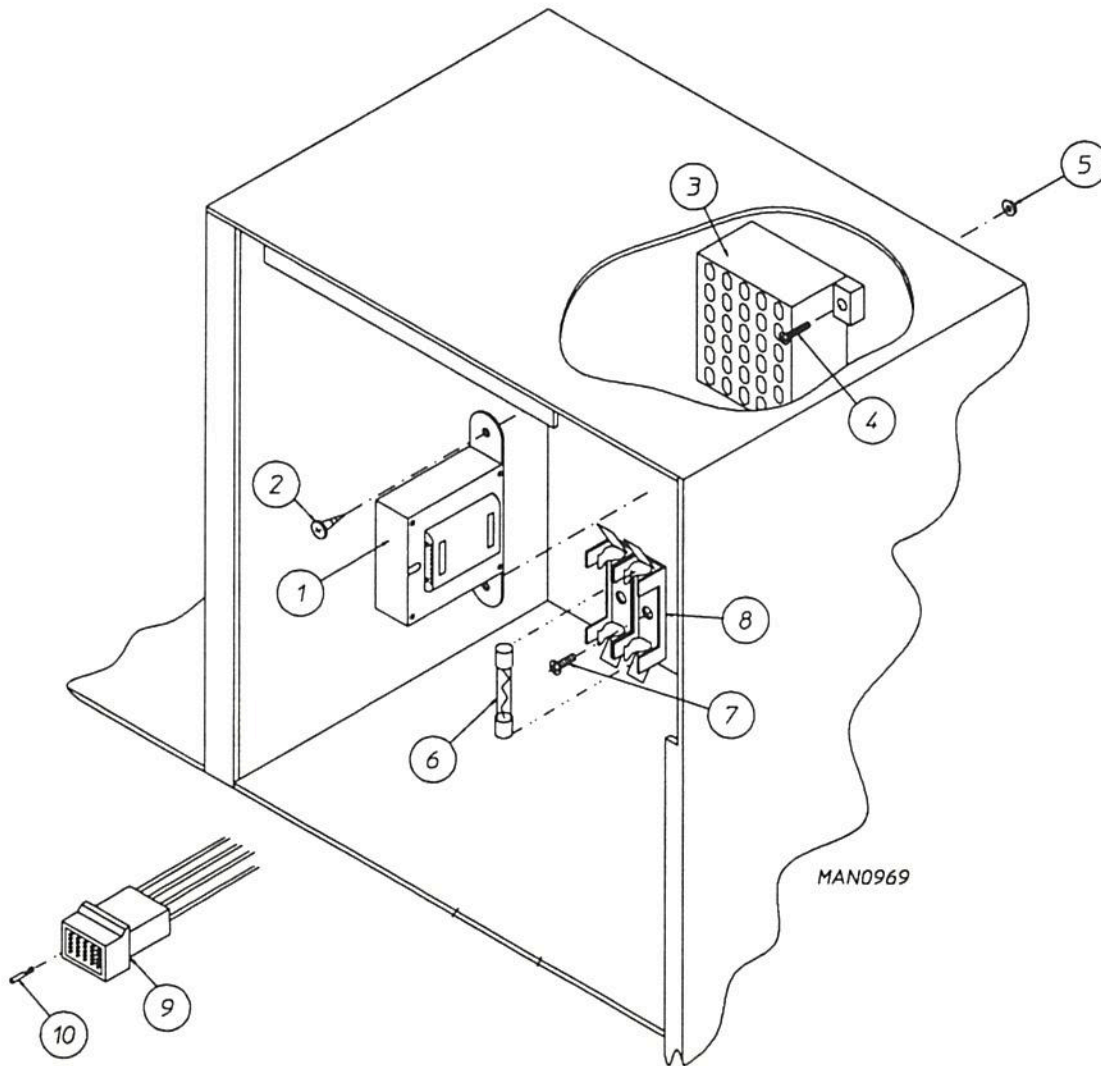

10/92	*COLOR CODE	(-)=NOT SHOWN	#=SERIES, SER PRE OR RUN NO.	MTLA71
-------	-------------	---------------	------------------------------	--------

Section: CONTROL BOX ASSEMBLY (NON-COMPUTER)

P/N 160022!

Models:

MDG30MC2A(*)

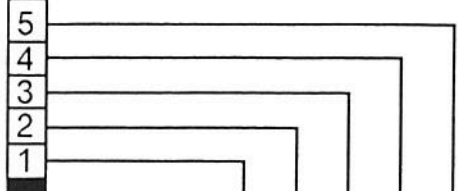

NO.	PART NUMBER	DESCRIPTION	#SEE BELOW	1	2	3	4	5
1	122603	Connector (9-Pin Socket)		1				
2	122701	Socket Terminal Only		9				
	122801	Pin-Socket Extraction Tool		1				
3	315010	Bracket (9-Pin Connector)		1				
4	150300	Tek Screw (#10 x 1/2" Hex Washer)		2				
5	150300	Tek Screw (#10 x 1/2" Hex Washer)		2				
6	141403	Transformer (DSI 24VAC)		1				
7	136008	Fuse Block/Strip Only (As Required)		-				
8	136057	Fuse (1/2 Amp Slo Blo)(As Required)		-				
9	150301	Tek Screw (#8 x 7/16" PH Pan HD-As Required)		-				
10	150002	Machine Screw (#6-32 x 1" Slotted RND HD)		2				
11	120715	Terminal Block (30-Position)		1				
12	151000	Pal Nut (#6-32)		2				

NOTE: Check Fusing On Dryer For Verification.

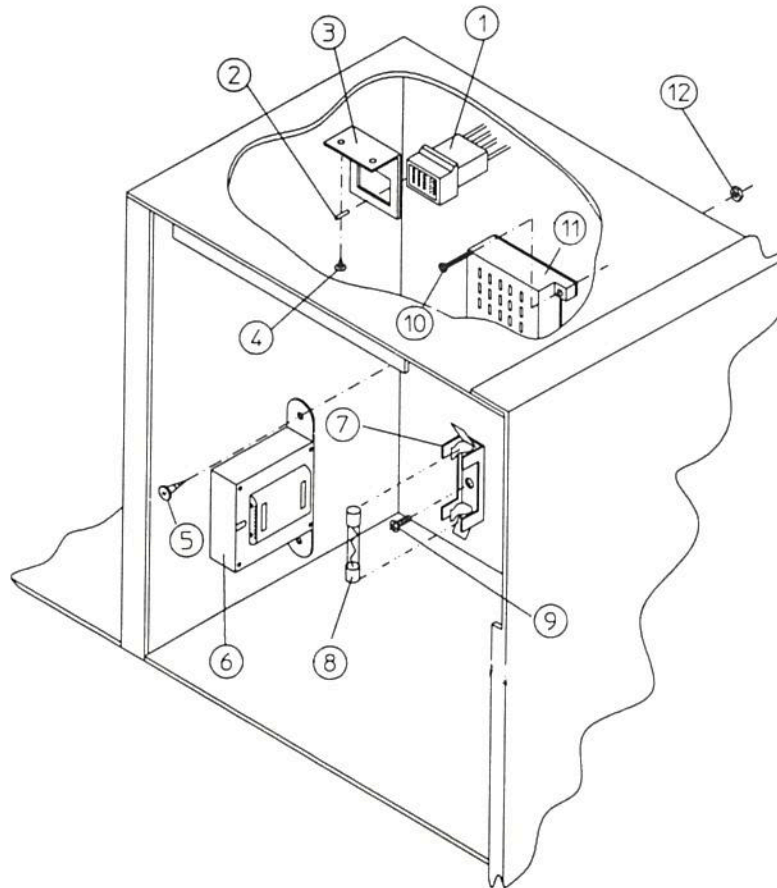

10/92

*COLOR CODE

(-)=NOT SHOWN

#=SERIES, SER PRE OR RUN NO.

MTLA72

Models:

MDG30MC2A(*)

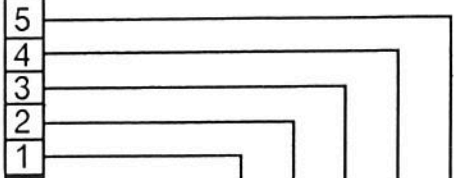

NO.	PART NUMBER	DESCRIPTION	#SEE BELOW	1	2	3	4	5
1	802112	Microprocessor Coin Vault Assy. Comp. (Incls. Ills. #1 - #6)	1					
	802117	Microprocessor Coin Vault Only	1					
	802110	Non-Microprocessor Coin Vault Assy. Comp. (Incls. Ills. #1 - #6)	1					
	802115	Non-Microprocessor Coin Vault Only	1					
2	160006	Cam For 1/4 Turn Lock Only	1					
3	875061	Lock W/Key & Cam (1/4 Turn)	1					
	160105	Mer-Pel Key (1/4 Turn)(Specify Key Number)	1					
4	802020	1/4 Turn Coin Box Assy. (Incls. Ills. #2 - #5)	1					
	802019	1/4 Turn Coin Box Only W/O Face Plate	1					
	125915	High Security (Greenwald) Coin Box Only W/Key	1					
5	802018	Coin Box Face Plate Only (1/4 Turn)	1					
6	152014	Wash Nut (1/4-20 Free Spin)	4					
7	102502	Control Door Support Rod	1					
8	102601	Control Door Rod Retainer Clip	1					
9	102600	Control Door Rod Catch	1					

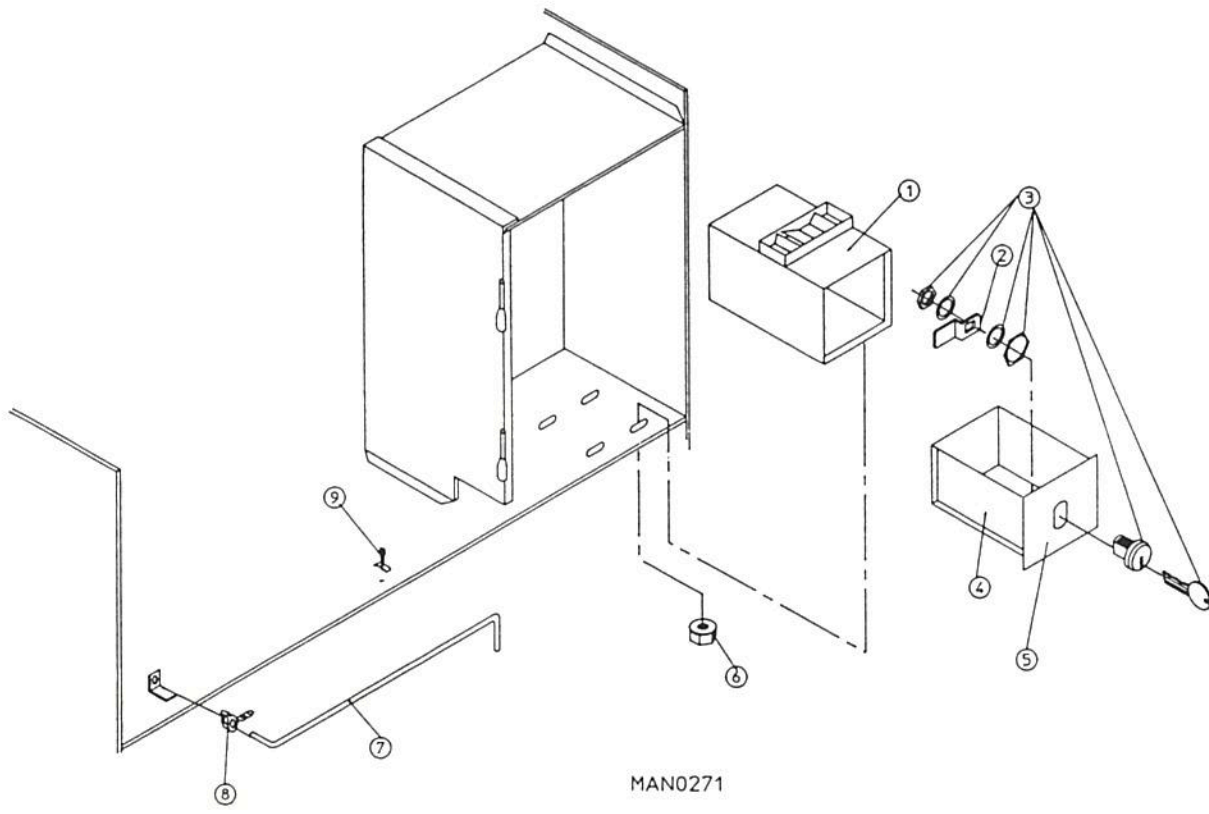

Section: ELECTRICAL RELAY PANEL ASSEMBLY

P/N 1600022

Models:

MDG30PN2A(*)
 MDG30PC2A(*)
 MDG30MC2A(*)

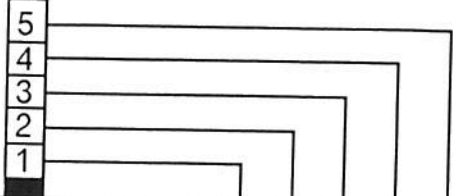

NO.	PART NUMBER	DESCRIPTION	#SEE BELOW	1	2	3	4	5
				1	2	3	4	5
1	132451	2-Pole Contactor (24VAC)		1	1	1		
2	150299	Tek Screw (#10 x 1" Hex)		2	2	2		
3	824828	RC Network W/Connectors		1	1	1		
-	322809	Electrical Box, Back Cover		1	1	1		
-	150301	Tek Screw (#8-18 x 7/16" PH.)		4	4	4		

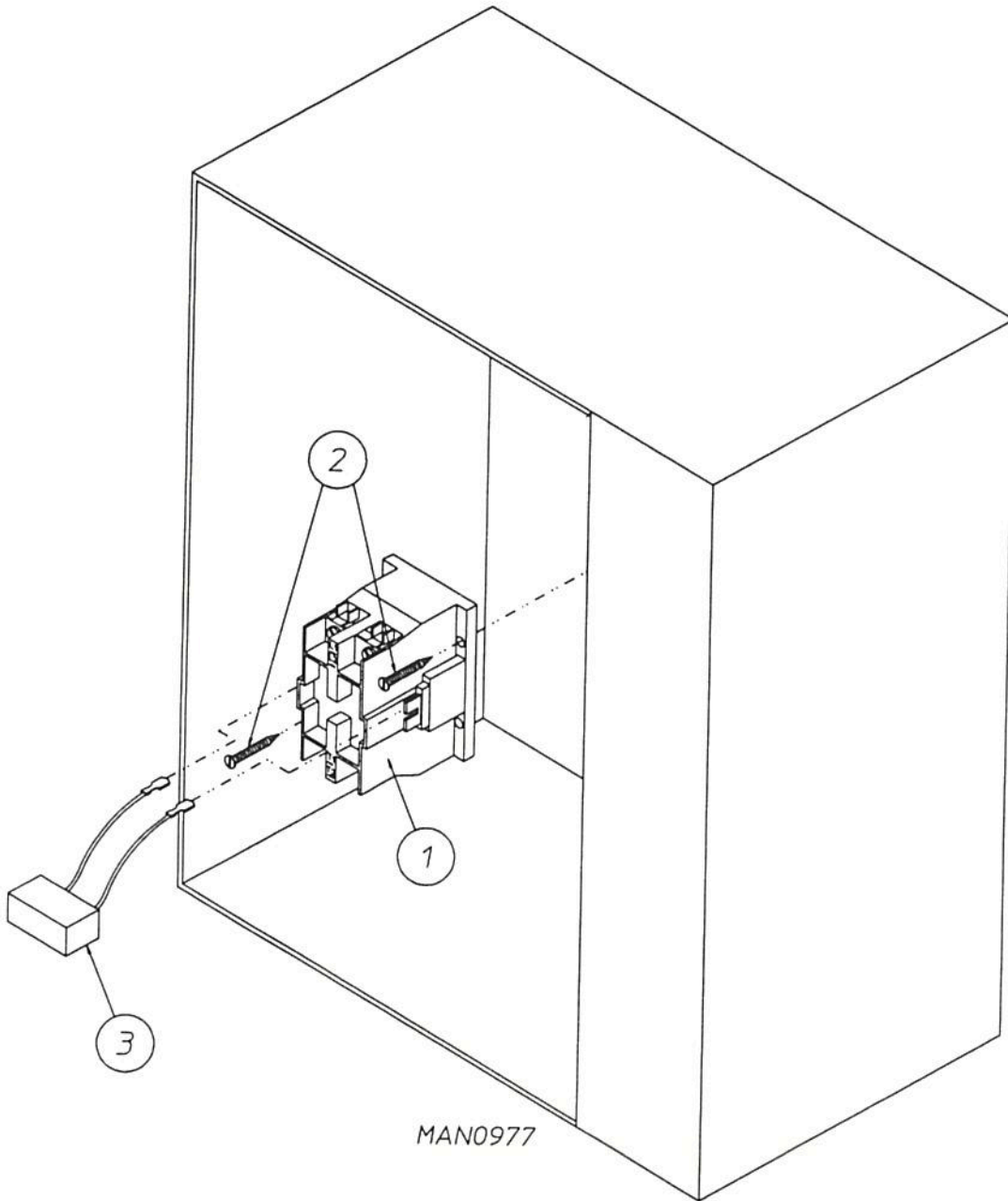

10/92	*COLOR CODE	(-)=NOT SHOWN	#=SERIES, SER PRE OR RUN NO.	MTLA74
-------	-------------	---------------	------------------------------	--------

Models:

MDG30PN2A(*)
 MDG30PC2A(*)
 MDG30MC2A(*)

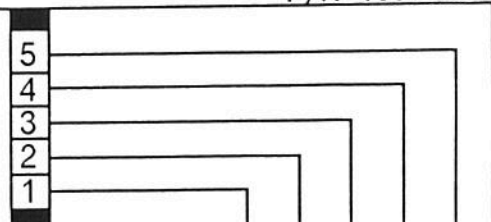

NO.	PART NUMBER	DESCRIPTION	#SEE BELOW					
				1	2	3	4	5
1	322809	Cover, Electrical Box (Rear)		1	1	1		
2	150301	Tek Screw (#8-18 x 7/16" PH. Pan HD.)		4	4	4		
3	314411	Backguard, Top		1	1	1		
4	150301	Tek Screw (#8-18 7/16" PH. Pan HD.)		7	7	7		
5	150301	Tek Screw (#8-18 x 7/16" PH. Pan HD.)		10	10	10		
6	312535	Guard, Top (Outer)		1	1	1		
7	314412	Backguard (Bottom)		1	1	1		
8	150301	Tek Screw (#8-18 x 7/16" PH. Pan HD.)		13	13	13		
9	103500	Leveling Legs		4	4	4		

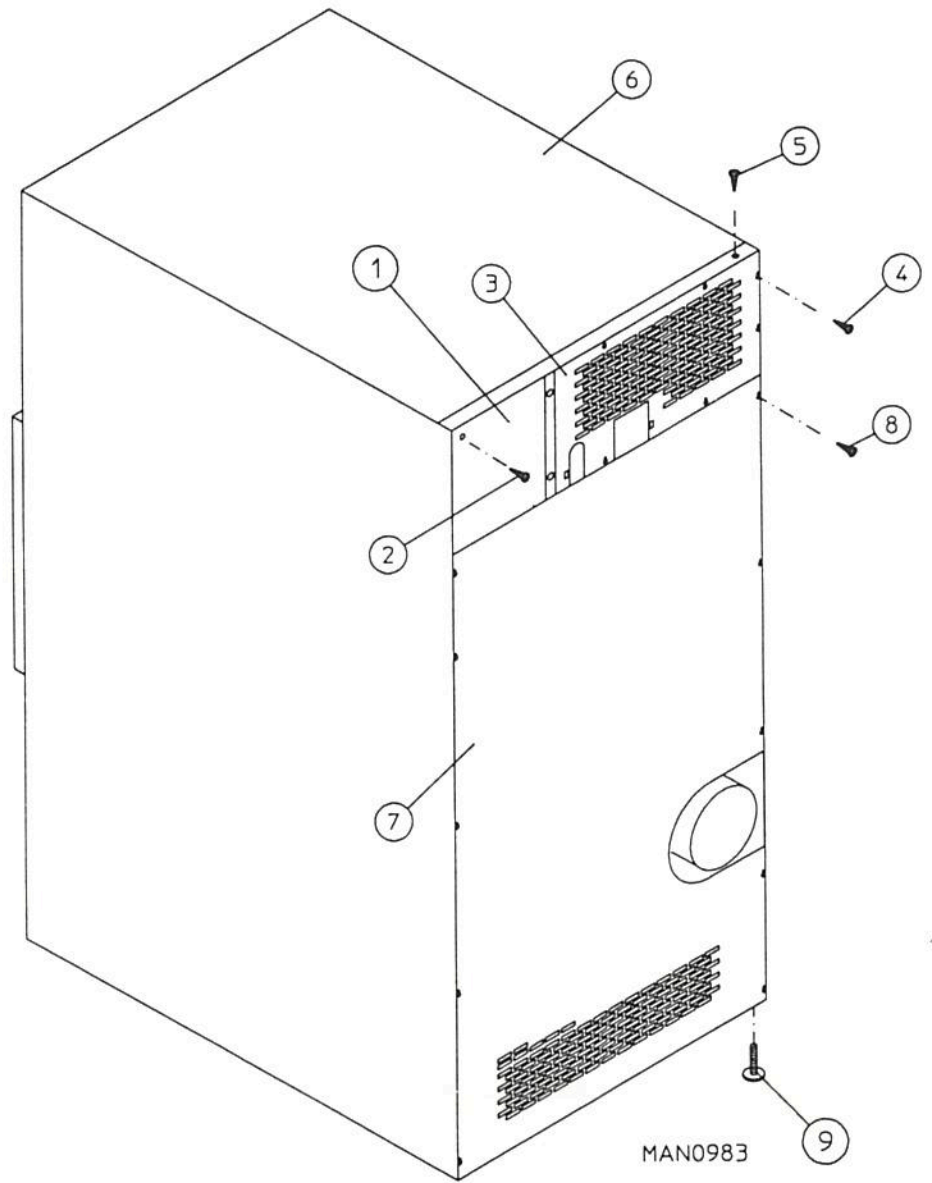

MAN0983

Models:

MDG30PN2A(*)
MDG30PC2A(*)
MDG30MC2A(*)

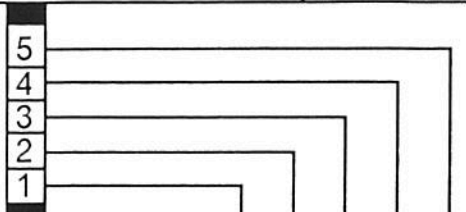

NO.	PART NUMBER	DESCRIPTION	#SEE BELOW	1	2	3	4	5
1	160017	Special Dummy Lock		1	1	1		
	160015	High Security (M/K-100 Lock Assy. W/Key Coin Models)		1	1	1		
	160104	Key (M/K-100)		1	1	1		
2	160016	Lock Cam Only		1	1	1		
3	870011	Logo Kit Only		1	1	1		
4	800023	Control Door Assy. (Incl. Illus. #4 - 7)		1	1	1		
5	180200	Top Trim Strip W/Lock Hole (38-1/4" Length)		1	1	1		
6	102307	Trim Bumper Gasket (Sold in Feet)		3	3	3		
7	150201	Machine Screw (#10-32 x 1/4" PH. Rnd. HD.)		5	5	5		
8	150300	Crimptite Screw (#10-32 x 1/2" PH. Rnd. HD.)		4	4	4		

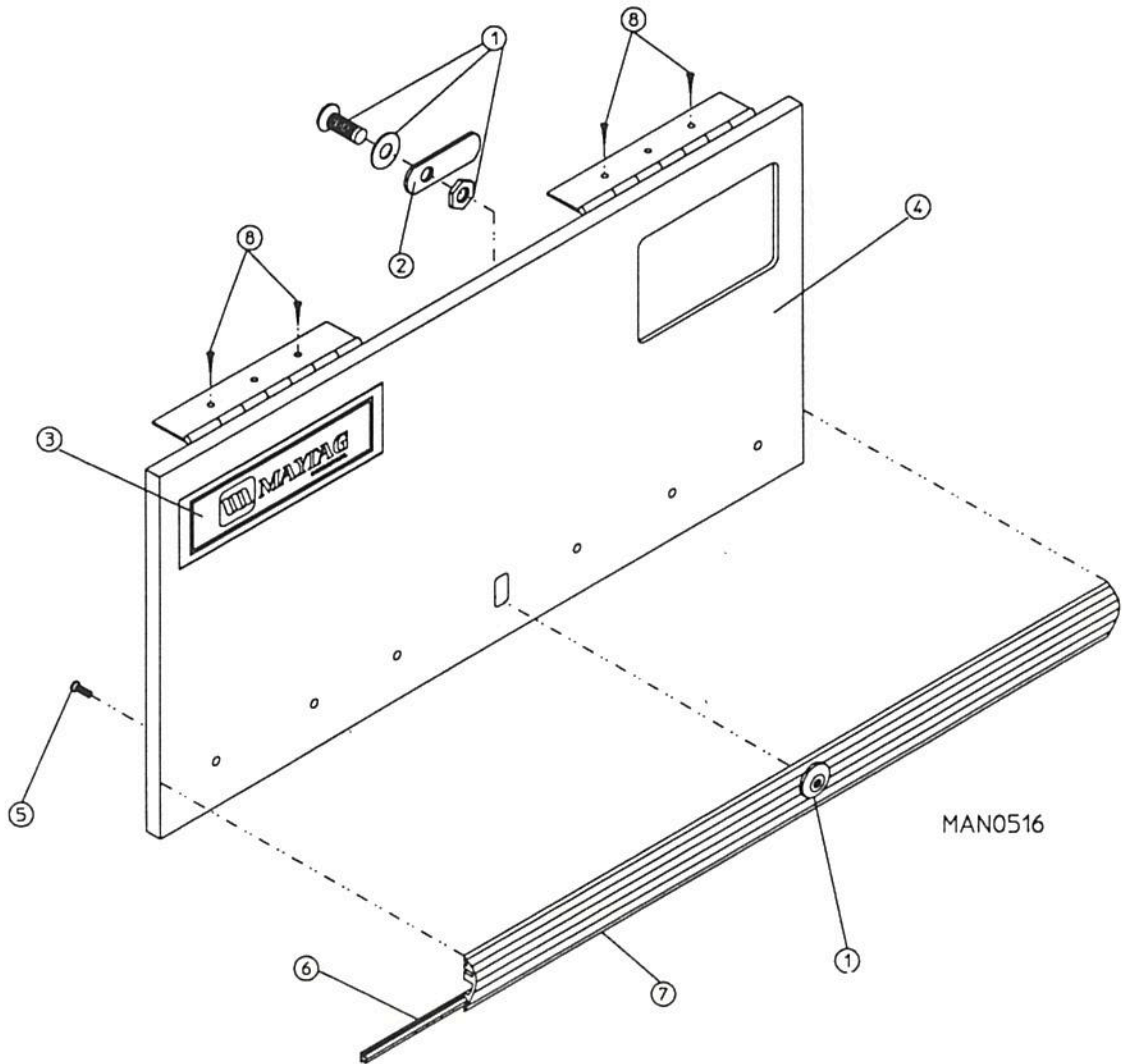

10/92

*COLOR CODE

(-)=NOT SHOWN

#=SERIES, SER PRE OR RUN NO.

MTLA76

Models:

MDG30PN2A(*)
 MDG30PC2A(*)
 MDG30MC2A(*)

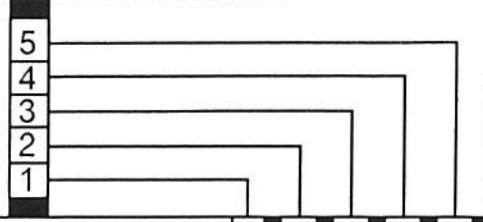

NO.	PART NUMBER	DESCRIPTION	#SEE BELOW				
			1	2	3	4	5
1	875300	Insulated, Front Panel Assy. Complete (Latch Type) (Incls. Illus. #1,#2,#3, & #6)	1	1	1		
2	154215	Pop Rivet (5/32")	2	2	2		
3	170330	Friction Door Latch	1	1	1		
4	150300	Tek Screw (#10 x 1/2", Hex Washer)	1	1	1		
5	150415	Screw, CrimpTite (#10-16 x 1/2", PH RND HD)	8	8	8		
6	121405	Grommet, Rubber	1	1	1		

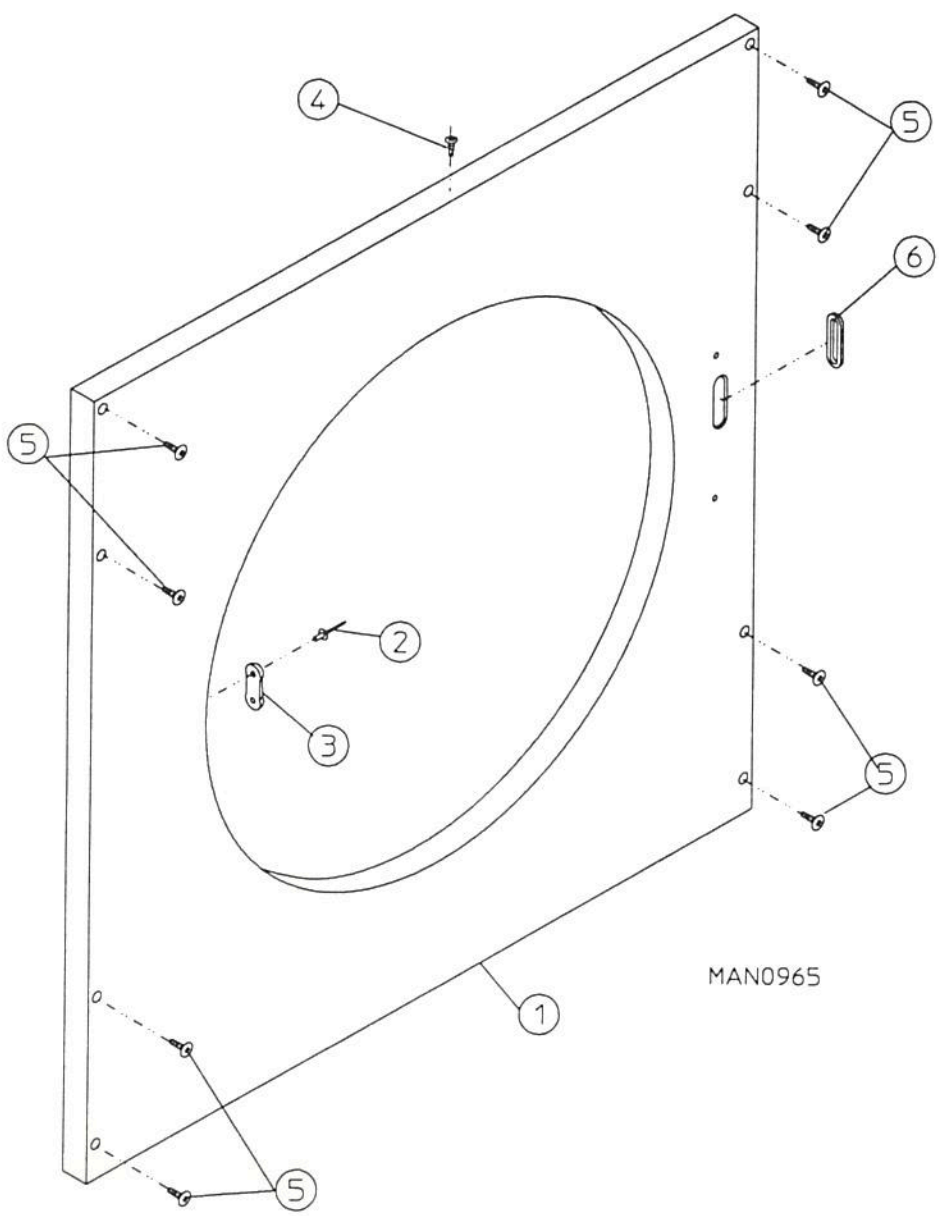

Models:

MDG30PN2A(*)
MDG30PC2A(*)
MDG30MC2A(*)

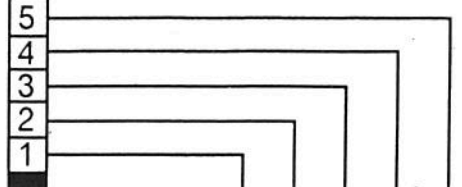

NO.	PART NUMBER	DESCRIPTION	#SEE BELOW	1	2	3	4	5
1	160001	Lock Assy. W/Key (AD-100)		1	1	1		
	160103	Key (AD-100)		1	1	1		
	800150	Knob Latch Kit Assy.(Incls. Ills.#1 & #2) (Non-Coin)		-	-	1		
	160200	Knob Latch W/2 Screws W/Out Cam (Non-Coin)		-	-	1		
	160003	Dummy Lock (Non-Coin)		1	1	-		
	160104	MK-100 Key (For Dummy Lock)		1	1	-		
2	160009	Knob Latch Adjustable Cam (Non-Coin)		-	-	1		
	150425	Machine Screw (#12-24 x 3/8" RND HD) (Screw, Knob Latch Adjustable Cam)		1	1	1		
3	157000	Drop Lint Door Spring		1	1	1		
4	800233	Insulated Drop Lint Door Assy. (Incl. Illus. #4 - #8)		1	1	1		
	800216	Drop Lint Door Assy. (Incls. Ills. #4 - #8)		1	1	1		
5	150201	(#10-32 x 1/4" PH Pan HD Tek Screw)		10	10	10		
6	117600	Noise Suppressor Tab (Sold in Feet)		7	7	7		
7	102307	Trim Bumper Gasket (Sold In Feet)		3	3	3		
8	180202	Trim/Kick Plate (31-1/8" Length)		1	1	1		
9	150419	Screw, Tek (#6 x 1/2" Tamperproof)		2	2	2		
10	108120	Chain, Drop Lint Door		1	1	1		
-	150418	Screw, Hand Driver (Tamperproof)		1	1	1		

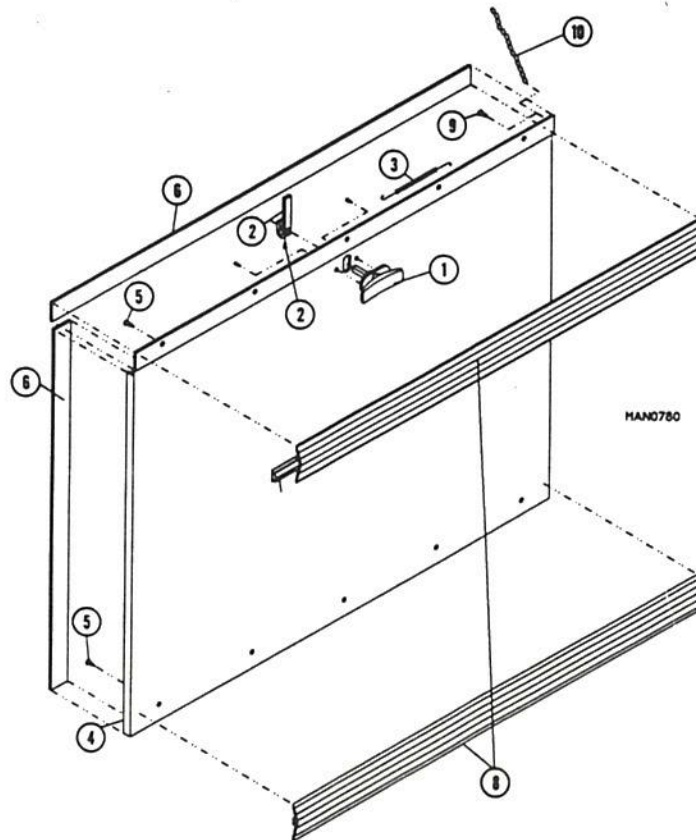

10/92	*COLOR CODE	(-)=NOT SHOWN	#=SERIES, SER PRE OR RUN NO.	MTLA78
-------	-------------	---------------	------------------------------	--------

Models:

MDG30PN2A(*)
MDG30PC2A(*)
MDG30MC2A(*)

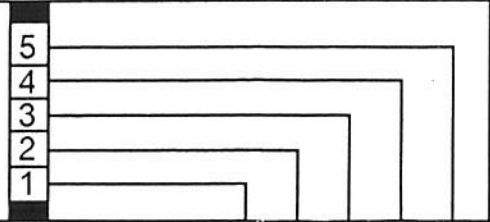

NO.	PART NUMBER	DESCRIPTION	#SEE BELOW	1	2	3	4	5
1	800285	Main Door Assy. Complete (Incls. Illus. #1,5,6 & 7)		1	1	1		
2	800448	Main Door Hinge Assy. (12-1/2" S.S.)		1	1	1		
3	150410	Taptite Screw (#10-24 x 3/8" PH Pan HD)		4	4	4		
4	152014	Free Spin Washer Nut (1/4-20)		4	4	4		
5	102353	Main Door Gasket (69-1/2")		1	1	1		
	170725	Main Door Gasket Adhesive (2.8 Oz. Tube)		1	1	1		
6	102210	Door Glass (20-7/16")		1	1	1		
	170730	Glass Adhesive for Main Door (10.3 Oz. Cartridge)		1	1	1		
7	150431	Main Door Latch Screw (#10 x 7/16" Dome Hex HD)		1	1	1		

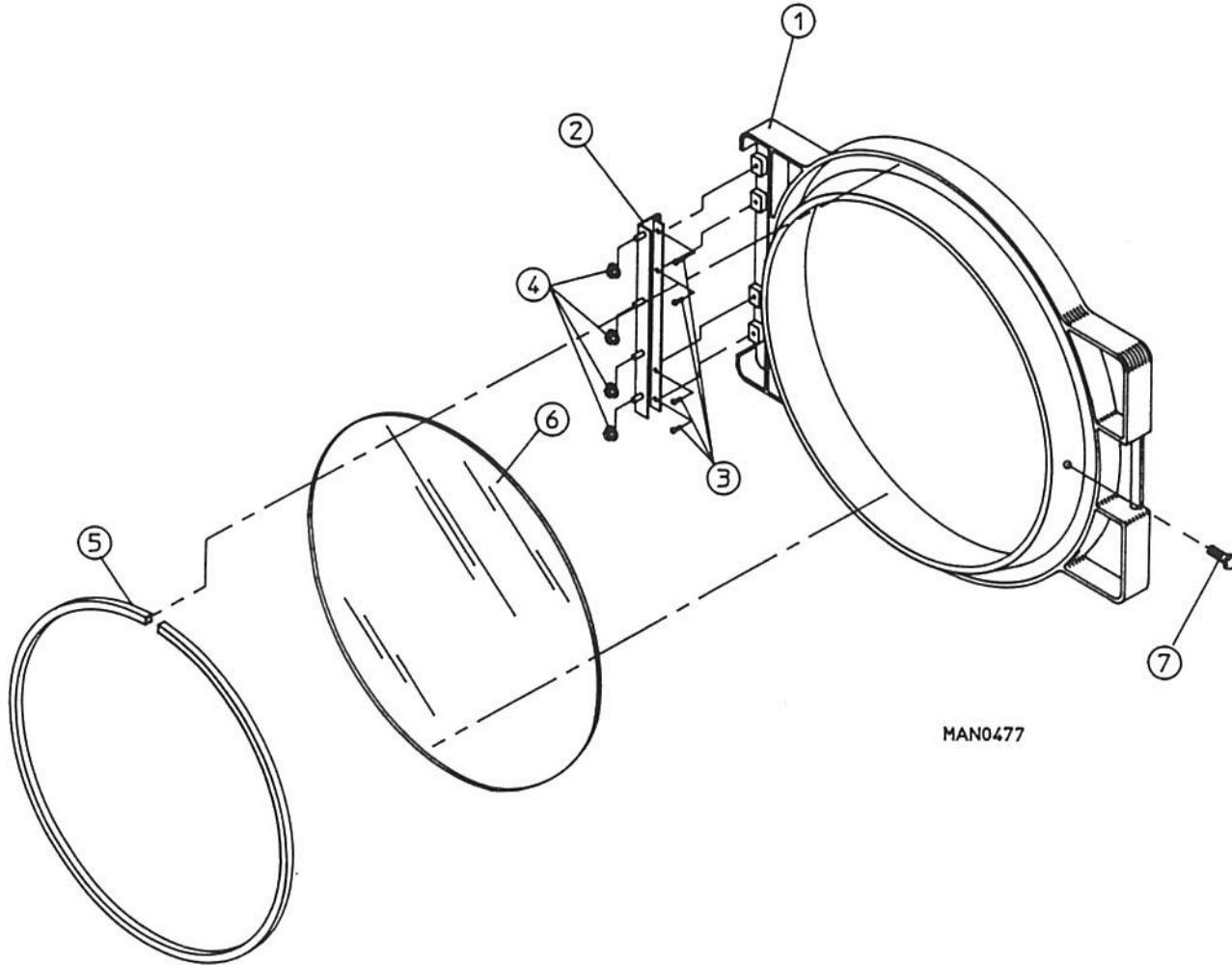

MAN0477

Section: MAIN DOOR SWITCH HOUSING

P/N 16000225

Models:

MDG30PN2A(*)
MDG30PC2A(*)
MDG30MC2A(*)

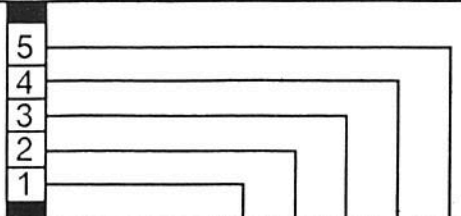

NO.	PART NUMBER	DESCRIPTION	#SEE BELOW	1	2	3	4	5
1	152013	Hex Nut (#6-32)		2	2	2		
2	153008	Washer, Split Lock (#6)		2	2	2		
3	137005	Single Pole Door Switch		1	1	1		
4	121028	Insulated Female Terminal		2	2	2		
5	154281	Standard Nylon Spacers (3/8")		2	2	2		
6	800448	Main Door Hinge Assy. (12 1/2" S.S.) (Incls. Ills. 6 & 7)		1	1	1		
7	153565	Self Clinching Stud (#6-32 x 1")		2	2	2		
8	313218	Main Door Switch Housing		1	1	1		
9	150201	Screw (#10-31 x 1/4" PH Pan HD)		2	2	2		
10	121405	Grommet, Rubber		1	1	1		

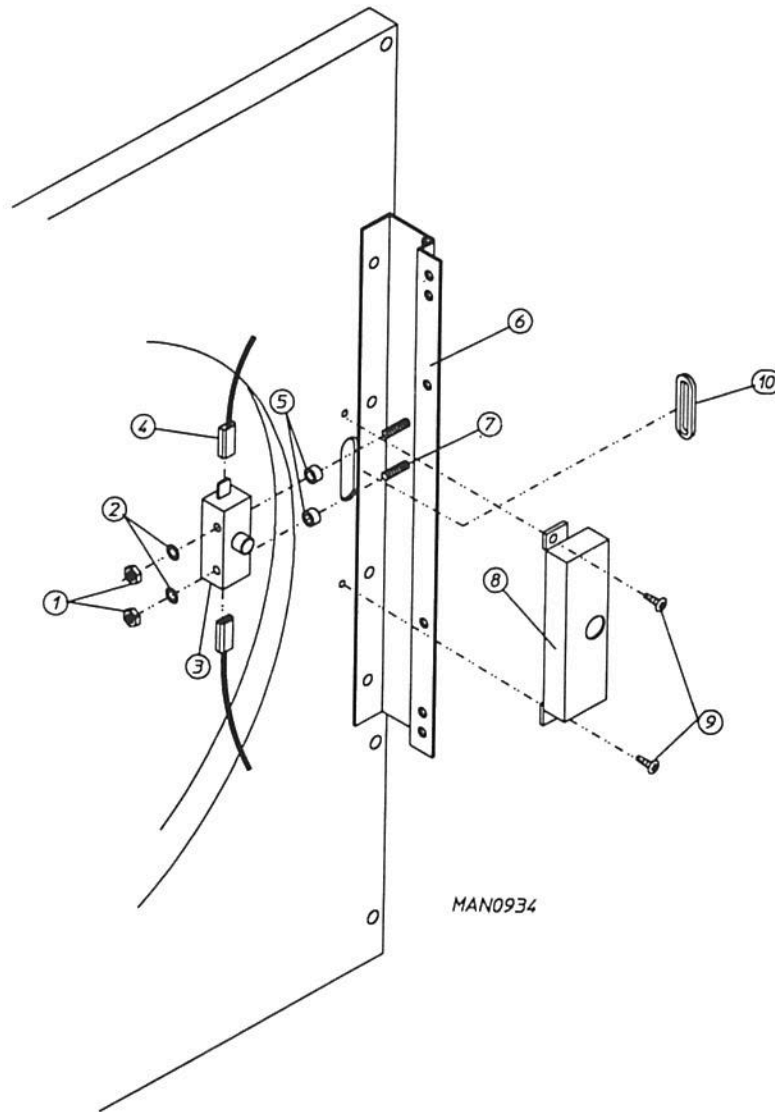

10/92

*COLOR CODE

(-)=NOT SHOWN

#=SERIES, SER PRE OR RUN NO.

MTLA80

Models:

MDG30PN2A(*)
 MDG30PC2A(*)
 MDG30MC2A(*)

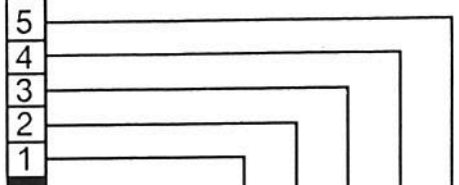

NO.	PART NUMBER	DESCRIPTION	#SEE BELOW	1	2	3	4	5
1	800408	Lint Trap Assy. Complete (Incls. Illus. #1, 3, 4 & 5)		1	1	1		
	800409	Lint Trap Only		1	1	1		
2	154200	Pop Rivet (5/32")		7	7	7		
3	304102	Lint Screen Holder		1	1	1		
4	150300	Tek Screw (#10 x 1/2" Hex Washer)		3	3	3		
5	800503	Lint Screen		1	1	1		
6	150419	Tek Screw (#6 x 1/2" Tamperproof)		2	2	2		
7	108120	Chain, Drop Lint Door (10-1/2" Length)		1	1	1		
-	150418	Screw Hand Driver (Tamperproof)		1	1	1		

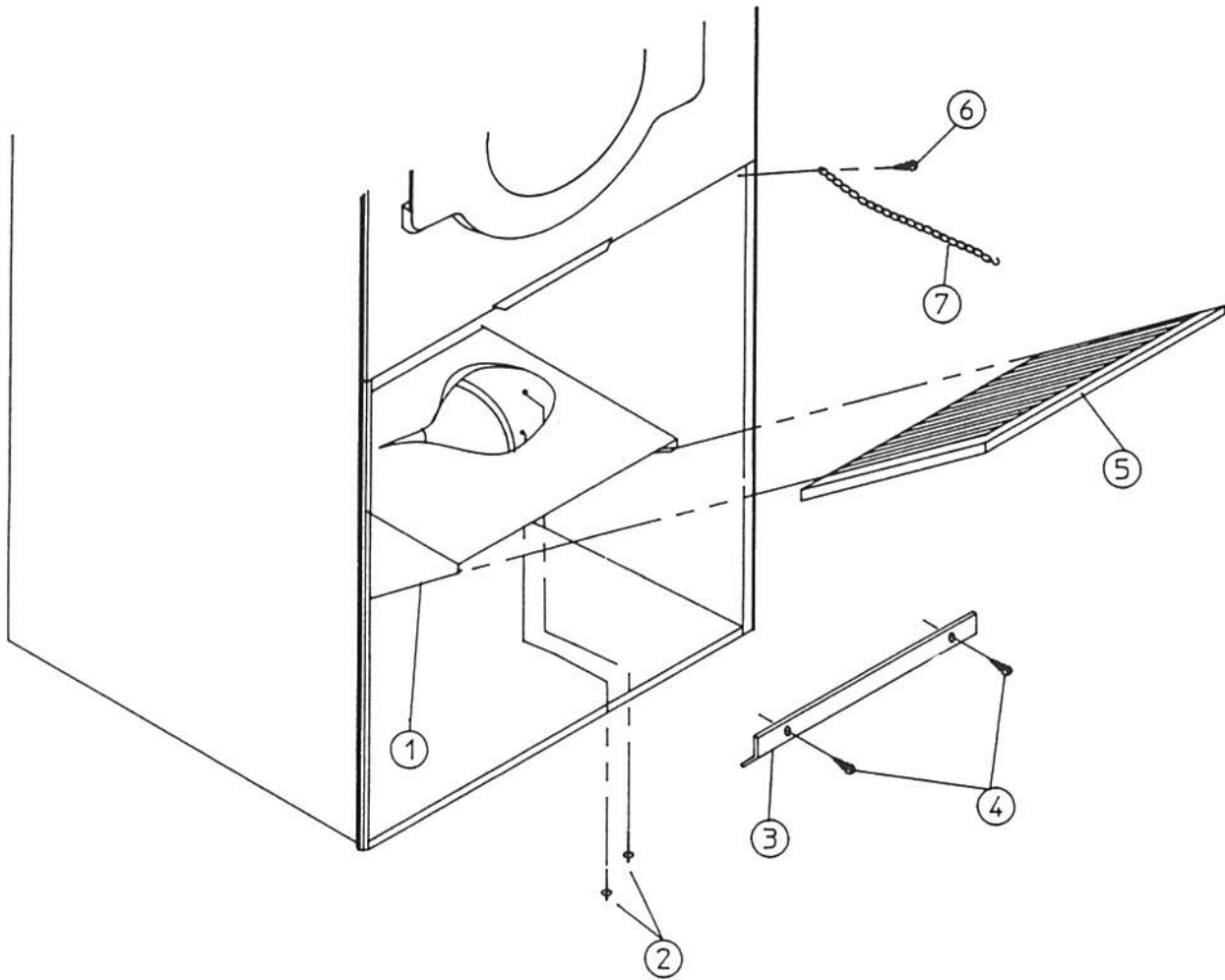

MAN0107

10/92	*COLOR CODE	(-)=NOT SHOWN	#=SERIES, SER PRE OR RUN NO.	MTLA81
-------	-------------	---------------	------------------------------	--------

Models:

MDG30PN2A(*)
MDG30PC2A(*)
MDG30MC2A(*)

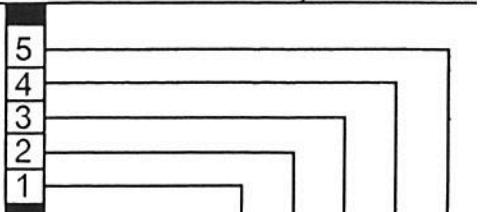

NO.	PART NUMBER	DESCRIPTION	#SEE BELOW					
				1	2	3	4	5
1	800703	Tumbler Only (W/O Felt Collar)		1	1	1		
	800803	Tumbler & Support Assy., Complete (Incls. Illus. #1 thru 10)		1	1	1		
2	150415	Crimptite Screw (#10-16 x 1/2" PH Rnd.HD)		40	40	40		
3	301304	Tumbler Rib Only		4	4	4		
4	150518	Screw (#5/16-18 x 3/8" Socket Button HD)		1	1	1		
5	100902	Tie Rod (#5/16-18 x 31")		4	4	4		
6	153001	Flat Washer (5/16")		4	4	4		
7	800603	Tumbler Support Only		1	1	1		
8	152004	Hex Nut (5/16"-18)		4	4	4		
9	153002	Lock Washer (5/16")		4	4	4		
10	153001	Flat Washer (5/16")		4	4	4		
11	116002	Felt Collar		1	1	1		
-	401010	#847 Adhesive For Felt Collar		1	1	1		

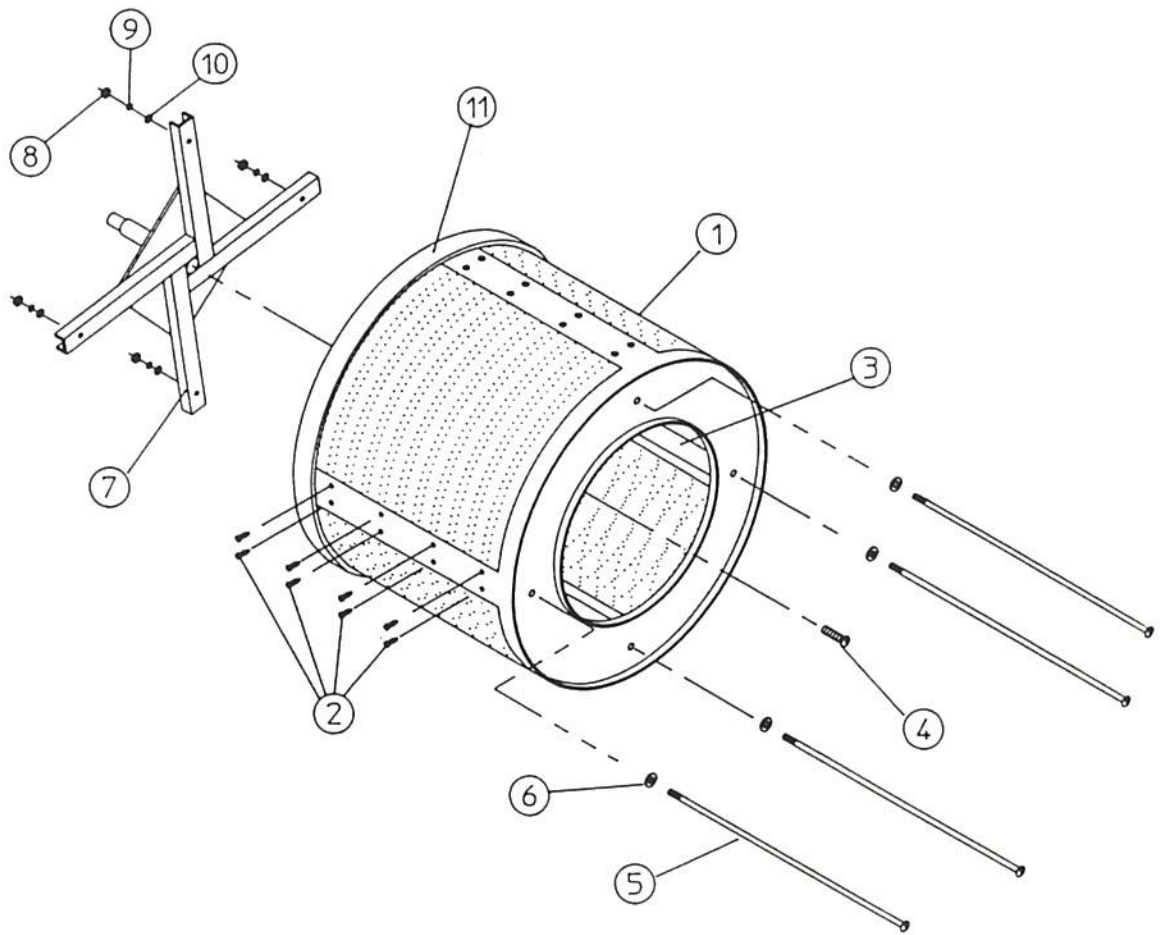

MAN0309

10/92	*COLOR CODE	(-)=NOT SHOWN	#=SERIES, SER PRE OR RUN NO.	MTLA84
-------	-------------	---------------	------------------------------	--------

Models: ALL MDG30 MODELS

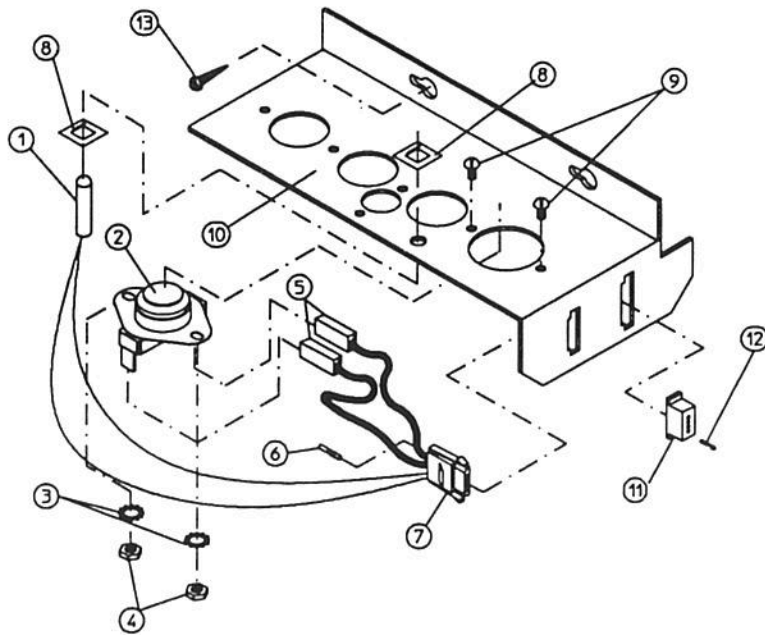

MICROPROCESSOR SENSOR BRACKET ASSEMBLY

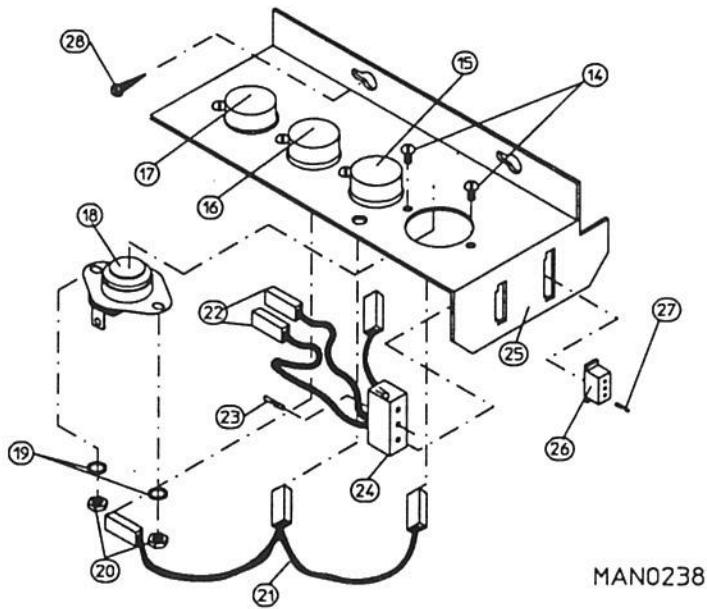

MAN0238

NON-COMPUTER SENSOR BRACKET ASSEMBLY

Section: SENSOR BRACKET ASSY. (MICROPROCESSOR & NON-COMPUTER) P/N 160022

Models:	5	MDG30PN2A(*) MDG30PC2A(*) MDG30MC2A(*)	
	4		
	3		
	2		
	1		

NO.	PART NUMBER	DESCRIPTION	#SEE BELOW	1	2	3	4	5
1	880251	Temperature Sensor Probe Assy. (1/4") (Includes 1 and 5 Through 8)	-	1	1			
2	130103	225° Large Thermostat	-	1	1			
3	153010	Star Washer (#6)	-	2	2			
4	152000	6-32 Hex Nut	-	2	2			
5	121028	Insulated Terminal	-	2	2			
6	122701	Socket Terminal	-	4	4			
7	122605	Connector (4-Pin Socket)	-	1	1			
	122801	Pin/Socket Extraction Tool	-	1	1			
8	154007	Push-On Fastener (1/4" Tinnerman)	2	2	2			
9	150005	Screw (6-32 x 1/4", Round Head)	-	2	2			
10	801425	Microprocessor Sensor Bracket Assy. Comp. (Includes 1 Through 10)	-	1	1			
	305007	Universal Sensor Bracket	-	1	1			
11	122604	4-Pin Connector	-	1	1			
12	122700	Pin Terminal	-	4	4			
13	150301	Screw (8-18 x 7/16")	-	2	2			
14	150005	Screw (6-32 x 1/4", Round Head)	2	-	-			
15	130100	150° Large Thermostat	1	-	-			
16	130103	225° Large Thermostat	1	-	-			
17	130106	170° Large Thermostat	1	-	-			
18	130111	130° Large Thermostat	1	-	-			
19	153010	Star Washer (#6)	5	-	-			
20	152000	Hex Nut (6-32)	5	-	-			
21	801430	Non-Computer Sensor Bracket Assy. Comp. (Incls. Ills. #14 - 25)	1	-	-			
22	840065	Sensor Jumper Only	1	-	-			
23	121028	Insulated Terminal Only	4	-	-			
24	122701	Socket Terminal Only	4	-	-			
25	122605	4-Pin Socket Connector Only	1	-	-			
	840085	Sensor Bracket Harness Assy. Comp. (Incls. Ills. #22, 23, & 24)	1	-	-			
	305007	Universal Sensor Bracket Only	1	-	-			
26	122604	4-Pin Connector Only	1	-	-			
27	122700	Pin Terminal Only (Qty. of 3 Or 4)	4	-	-			
	122801	Pin/Socket Extraction Tool	1	-	-			
28	150301	Screw (3-18 x 7/16")	2	-	-			

Models: ALL MDG30 MODELS

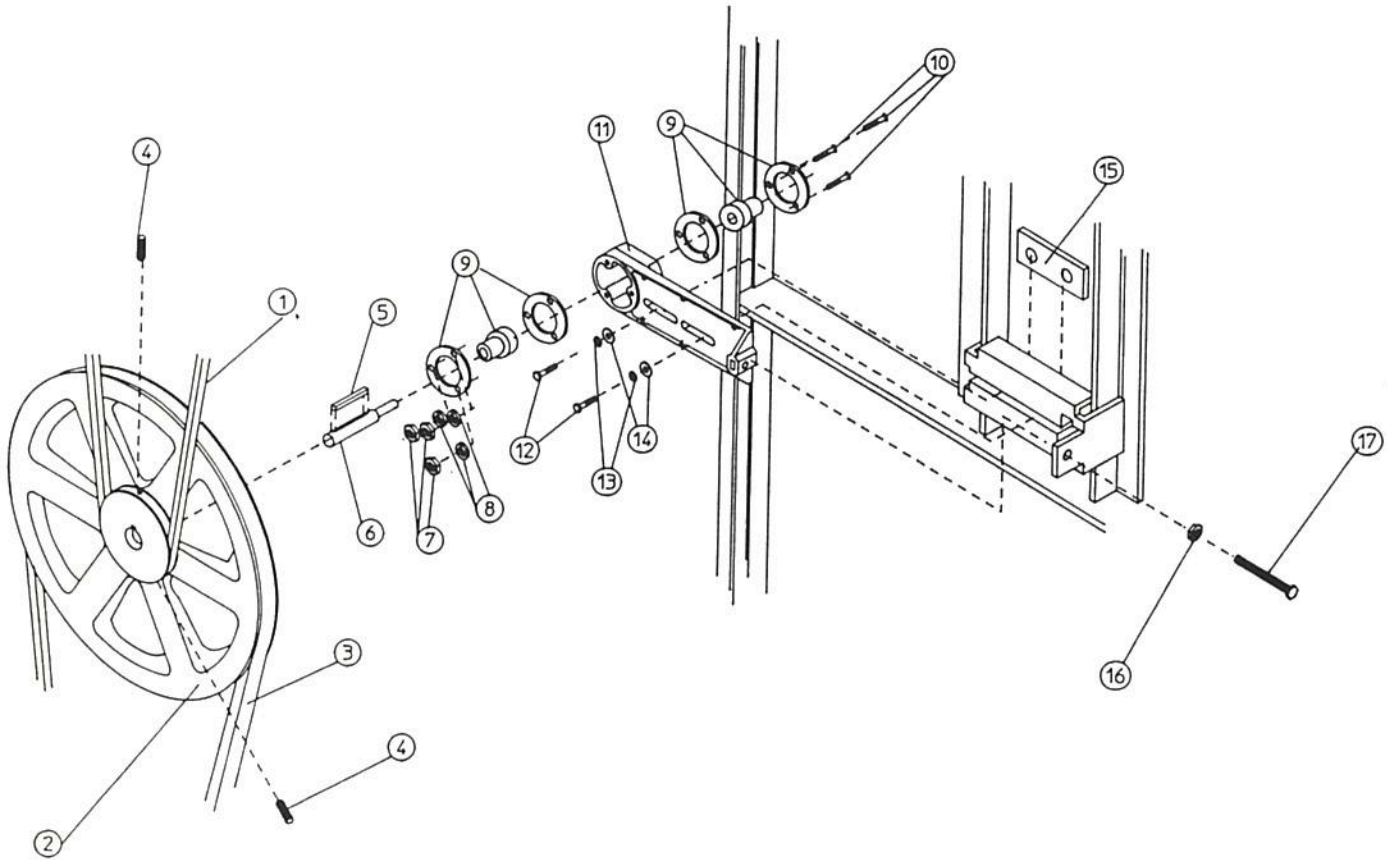

Models:

MDG30PN2A(*)
MDG30PC2A(*)
MDG30MC2A(*)

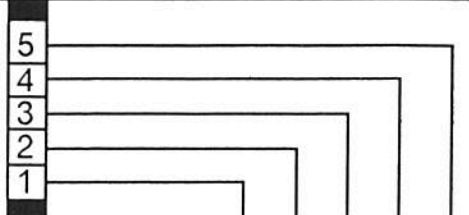

NO.	PART NUMBER	DESCRIPTION	#SEE BELOW	1	2	3	4	5
1	100108	Belt (5L680 "V") (Idler to Tumbler)		1	1	1		
2	101129	Compound Pulley (9" x 2 1/2")		1	1	1		
3	100110	Belt (4L500 "V") (Idler to Motor)		1	1	1		
4	154301	Screw (5/16"-18 x 5/16" Allen Set)		2	2	2		
5	100705	Key (3/16" x 3/16" x 1-3/8")		1	1	1		
6	301850	Idler Shaft (5/8" x 3/4")		1	1	1		
7	152002	Hex Nut (1/4"-20)		3	3	3		
8	153007	Lock Washer (1/4")		3	3	3		
9	100214	Flange Bearing (5/8")		2	2	2		
10	150521	Carriage Bolt (1/4"-20 x 2")		3	3	3		
11	801007	Idler Bearing Assy., Complete (Incls. Ills. #5 thru 17)		1	1	1		
12	150617	Machine Bolt (3/8"-16 x 1" Hex HD)		2	2	2		
13	153005	Lock Washer (3/8")		2	2	2		
14	153004	Flat Washer (3/8")		2	2	2		
15	801009	Idler Square Washer		1	1	1		
16	152004	Hex Nut (5/16"-18)		1	1	1		
17	150509	Machine Bolt (5/16"-18 x 3" Hex HD)		1	1	1		

Models: ALL MDG30 MODELS

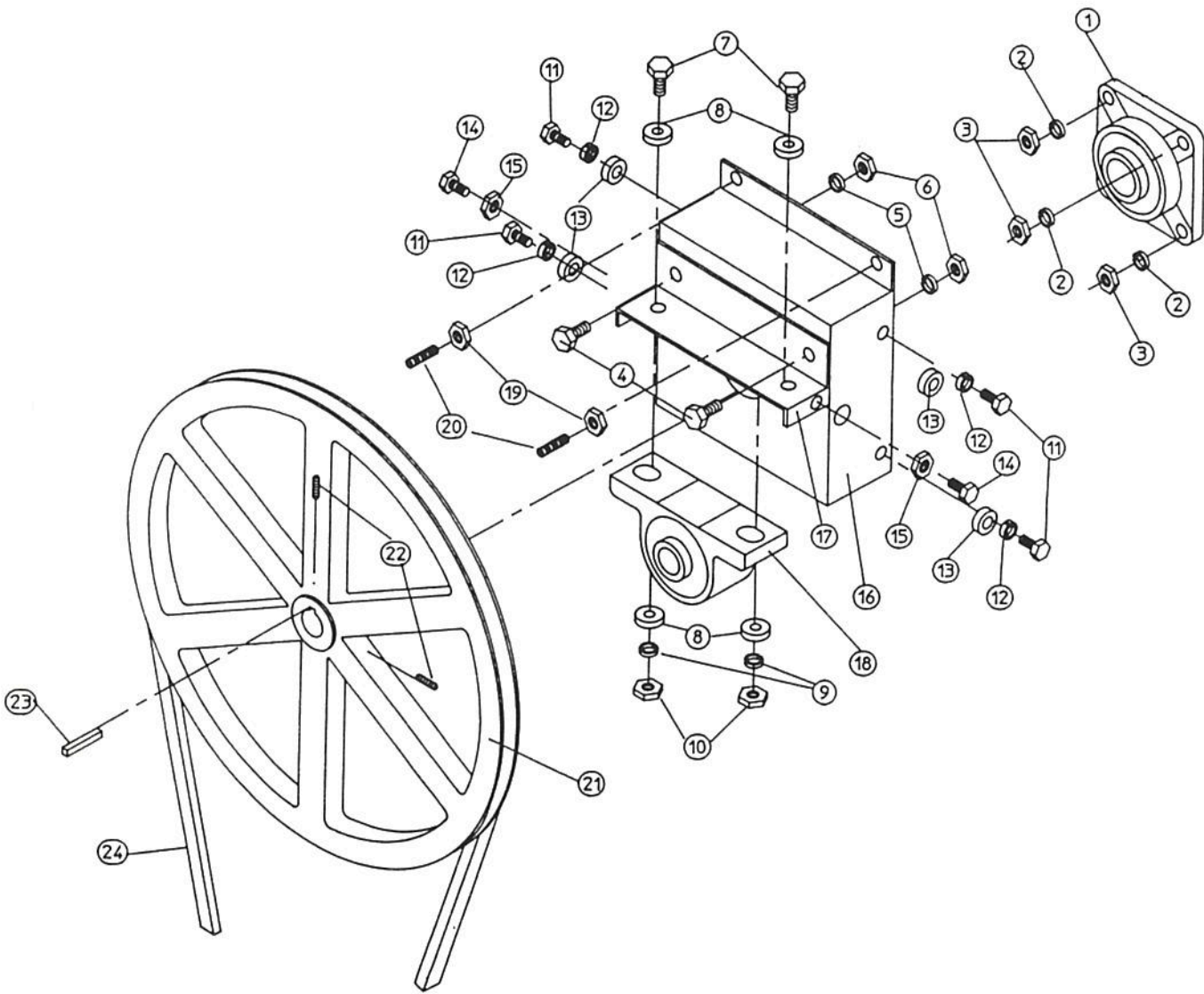

Section: TUMBLER-BEARING ASSEMBLY

P/N 1600022:



NO.	PART NUMBER	DESCRIPTION	#SEE BELOW	1	2	3	4	5
1	100203	Flange Bearing (1-3/8")		1	1	1		
2	153005	Lock Washer (3/8")		4	4	4		
3	152005	Hex Nut (3/8"-16)		4	4	4		
4	150508	Hex Head Machine Bolt (3/8"-16 x 3/4")		2	2	2		
5	153005	Lock Washer (3/8")		2	2	2		
6	152005	Hex Nut (3/8"-16)		2	2	2		
7	150600	Hex Head Machine Bolt (3/8"-16 x 1-1/2")		2	2	2		
8	153004	Flat Washer (3/8")(As Required)		-	-	-		
9	153005	Lock Washer (3/8")		2	2	2		
10	152005	Hex Nut (3/8"-16)		2	2	2		
11	150501	Hex Head Machine Bolt (5/16"-18 x 3/4")		4	4	4		
12	153002	Lock Washer (5/16")		4	4	4		
13	153001	Flat Washer (5/16")		4	4	4		
14	150621	Hex Head Machine Bolt (5/15"-18 x 1-1/2")		2	2	2		
15	152004	Hex Nut (5/16"-18)		2	2	2		
16	801101	Bearing Box Assy. Comp. (1-3/8") (Incls. Ills. #4 - #20)		1	1	1		
	801103	Bearing Box & Support Only (1-3/8") (Incls. Ills. #4, #5, #6, #16, & #17)		1	1	1		
	801105	Bearing Box Only (1-3/8")		1	1	1		
17	801104	Pillow Block Bearing Support Only		1	1	1		
18	100202	Pillow Block Bearing (1-3/8")		1	1	1		
19	152004	Hex Nut (5/16"-18)		2	2	2		
20	150610	Allen Set Screw (5/16"-18 x 1-1/2")		2	2	2		
21	101100	Pulley (18")		1	1	1		
22	154301	Allen Set Screw (5/16"-18 x 5/16")		2	2	2		
23	100713	Key (1/4" x 1/4" x 7/8")		1	1	1		
24	100108	Belt (5L680 "V") (Tumbler To Idler)		1	1	1		

Models: ALL MDG30 MODELS

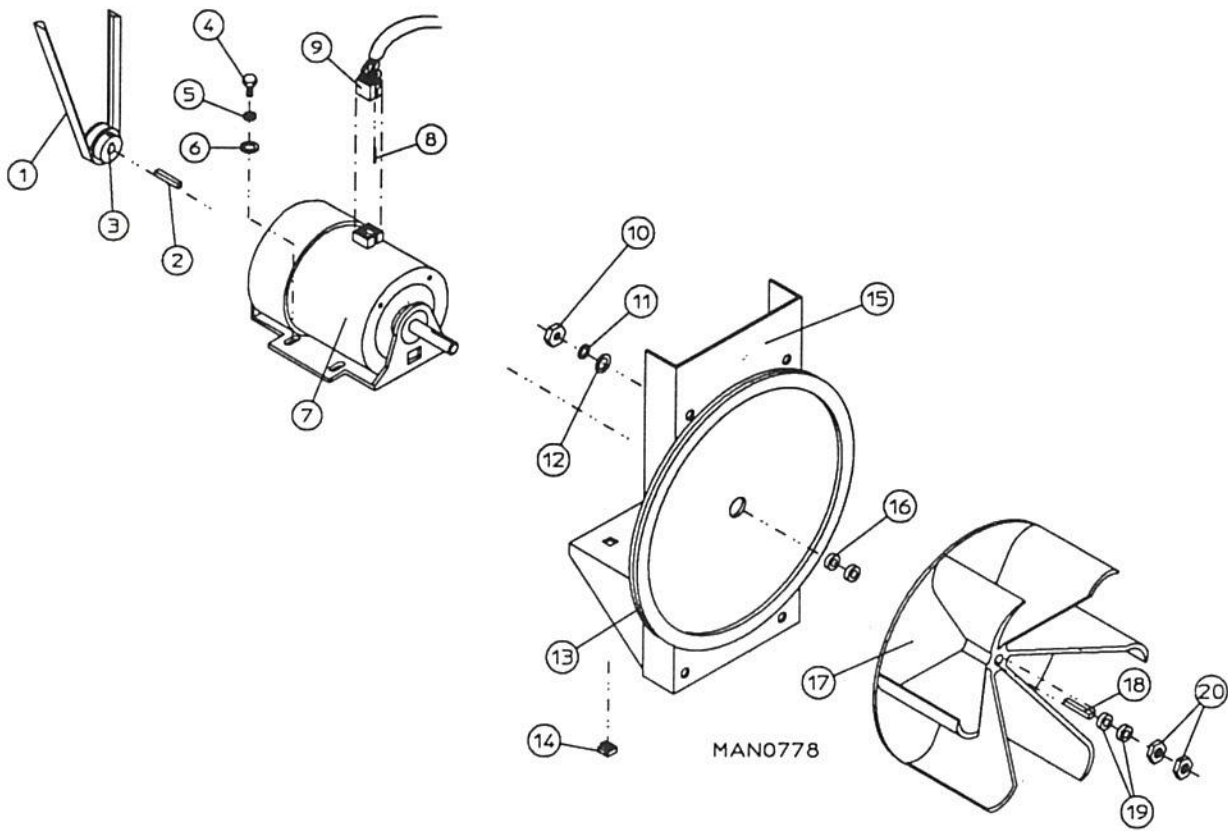

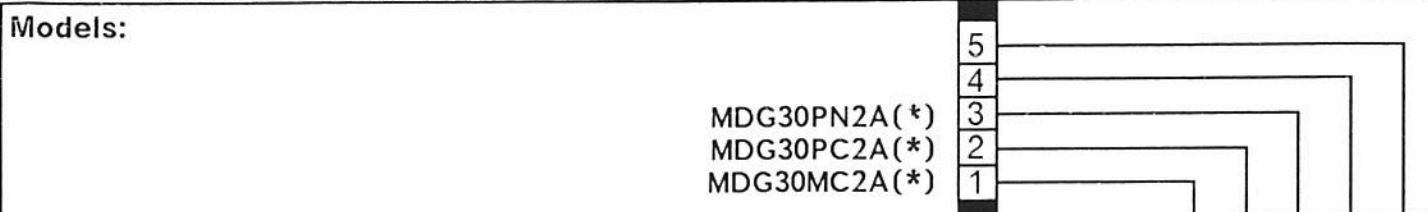

NO.	PART NUMBER	DESCRIPTION	#SEE BELOW	1	2	3	4	5
1	100110	Belt (4L500 "V") (To Idler Assy.)		1	1	1		
2	100701	Key (3/16" x 3/16")		1	1	1		
3	101104	Motor Pulley (1/2" x 2") (Used On 1, 60Hz Motors Only)		1	1	1		
4	150501	Hex Head Machine Bolt (5/16-18 x 3/4")		4	4	4		
5	153002	Lock Washer (5/16")		4	4	4		
6	153001	Flat Washer (5/16")		4	4	4		
7	100065	Motor (1/2 HP, 60Hz, 10, T.E.F.C.)(Plug Type)		1	1	1		
8	122701	Socket Terminal Only		8	8	8		
	122801	Pin/Socket Extraction Tool		1	1	1		
9	137030	Connector (8-Pin Housing)		1	1	1		
10	152004	Hex Nut (5/16"-18)		4	4	4		
11	153002	Lock Washer (5/16")		4	4	4		
12	153001	Flat Washer (5/16")		4	4	4		
13	117600	Noise Suppressor Tape (Sold In Feet)		4	4	4		
14	154000	Tinnerman Nut (5/16"-18)		4	4	4		
15	800908	1/2 HP Motor Mount Only (56Z Frame)		1	1	1		
**	803938	1/2 HP, 115v, 60Hz, 10, T.E.F.C. Motor Mount Assy.Comp. W/Plug Motor (Incls. Ills. #3 - #7 & #13 - #20)		1	1	1		
16	153050	Flat Washer (1/2" S.A.E.)		2	2	2		
17	100604	Impellor (12-1/2") With 1/2" Bore		1	1	1		
18	100702	Key (1/8" x 1/8" x 1-1/2")		1	1	1		
19	153050	Flat Washer (1/2" S.A.E.)		2	2	2		
20	152006	Left Hand Jam Nut (1/2"-20)		2	2	2		

** NOTE: Specify Voltage When Ordering

Models: ALL MDG30 MODELS

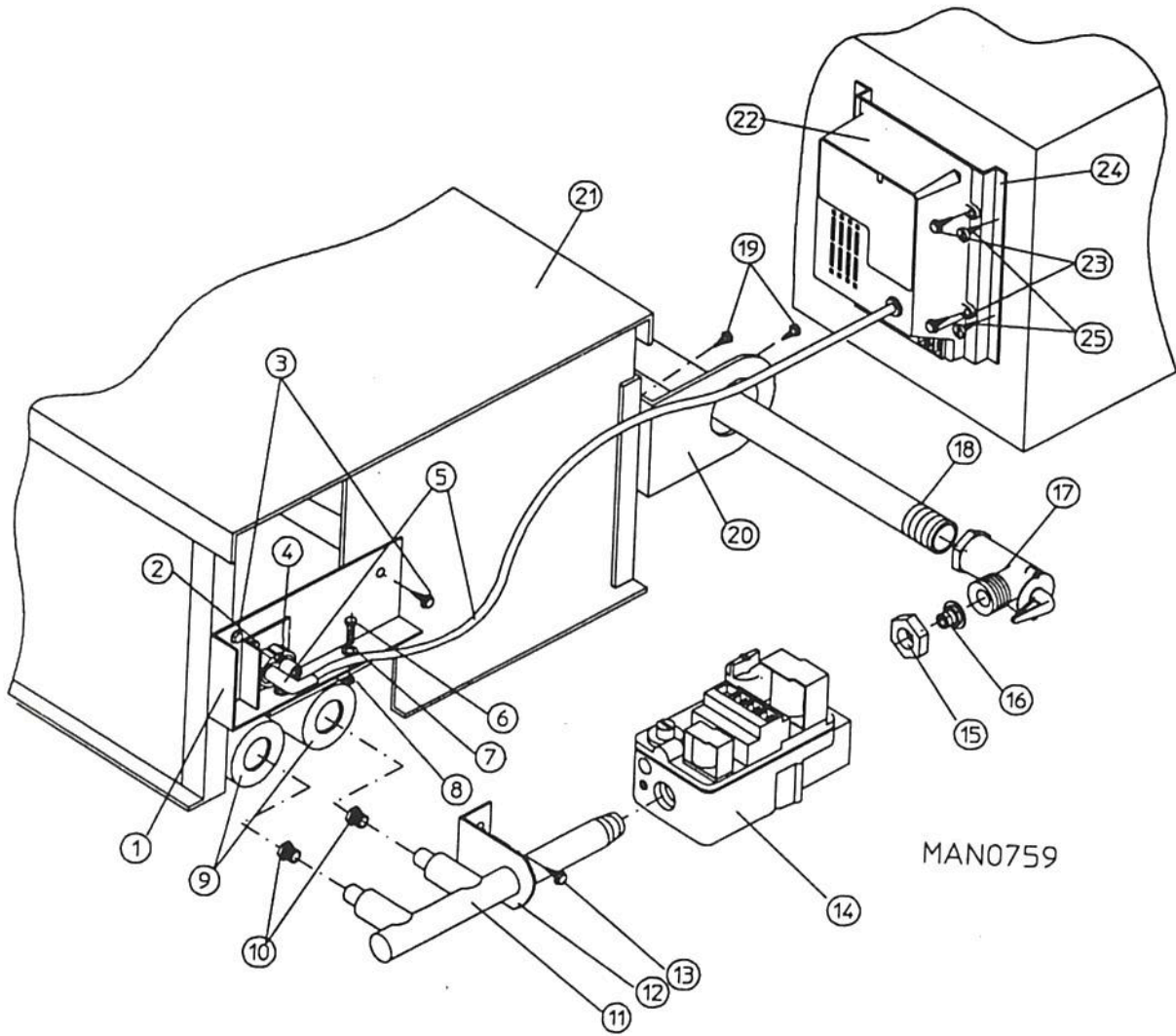

Models:

MDG30PN2A(*)
MDG30PC2A(*)
MDG30MC2A(*)

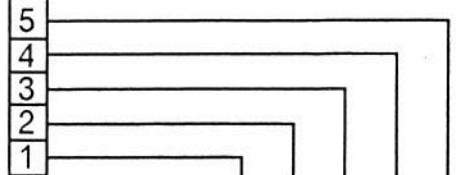

NO.	PART NUMBER	DESCRIPTION	#SEE BELOW	1	2	3	4	5
1	318030	DSI Burner Shield		1	1	1		
2	150300	Tek Screw (#10 x 1/2" Hex Washer)		2	2	2		
3	150415	Crimptite Screw (#10-16 x 1/2" PH RND HD)		2	2	2		
4	128915	DSI Igniter/Flame Probe Assy.		1	1	1		
	880134	Igniter/Flame Probe Kit Assy. (Incls. Ills. #4, #5 & #6)		1	1	1		
5	880330	Connector Assy. & HV Wire		1	1	1		
6	150103	Pan Head Machine Screw (#8-32 x 1/2")		2	2	2		
7	153000	Steel Burr (#8)		2	2	2		
8	151001	Pal Nut (#8-32)		2	2	2		
9	141105	Large Tube Burner		2	2	2		
**10	140819	Burner Orifice (Natural Gas)		2	2	2		
	140806	Burner Orifice (L.P. Gas)		2	2	2		
11	141230	DSI Manifold 2-Port (1/2")		1	1	1		
12	318700	Pipe Bracket (Bent)		1	1	1		
13	150300	Hex Washer Tek Screw (#10 x 1/2")		2	2	2		
14	128927	Redundant Gas (1/2" 24 Vac) Valve (Natl. Gas)		1	1	1		
	140411	Valve Conversion Kit (1/2") (Liquid Propane)		1	1	1		
15	141325	Tail Piece Collar Only		1	1	1		
16	141303	Union Tail Piece Only (1/2")		1	1	1		
17	141305	Union Shut-Off Body Only		1	1	1		
18	142809	Pipe (1/2" x 29-1/8")		1	1	1		
19	150415	Crimptite Screw (#10-16 x 1/2" PH RND HD)		4	4	4		
20	318700	Pipe Bracket (Bent)		2	2	2		
21	850851	Non-Heat Reclaimer Burner Box Only		1	1	1		
	850861	Heat Reclaimer Burner Box Only		1	1	1		
***	809631	Burner Assy. Comp. (Less Orifice Natural Gas)		1	1	1		
***	809632	Burner Assy. Comp. (Less Orifice L.P. Gas)		1	1	1		
22	880815	DSI Module Only (50Hz/60Hz)		1	1	1		
23	150299	Tek Screw (#10 x 1" Hex Washer)		4	4	4		
24	319505	DSI Module Bracket		1	1	1		
25	150301	Tek Screw (#8 x 7/16" PH Pan HD)		-	-	-		
**	874050	L.P. Conversion Kit		1	1	1		
-	410001	Allen Wrench (1/2")		1	1	1		

** Consult Factory For Elevations Over 2000 Ft.
*** Specify Computer or Non-Computer

1/94

*COLOR CODE

(-)=NOT SHOWN

#=SERIES, SER PRE OR RUN NO.

MTLA88

Models:

MDG30PN2A(*)
MDG30PC2A(*)
MDG30MC2A(*)

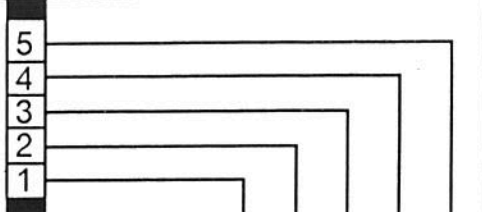

NO.	PART NUMBER	DESCRIPTION	#SEE BELOW	1	2	3	4	5
1	154004	Twin Speed Nut		1	1	1		
2	150415	10-16x1/2" Screw		2	2	2		
3	802799	Sail Switch Box Cover & Bracket Only		1	1	1		
4	150303	#4x3/4" Screw		2	2	2		
5	122200	Sail Switch		1	1	1		
6	105500	Sail Switch Actuator Rod		1	1	1		
7	319202	Sail Switch Damper (Flat)		1	1	1		
8	154002	1/8" Push-On Fastener		1	1	1		
9	802800	Sail Switch Box with Cover and Bracket Only		1	1	1		
	802801	Sail Switch Box Assy. Comp. (Incl. 1 - 8)		1	1	1		
10	142809	1/2"x29-1/8" Pipe		1	1	1		
11	150415	10-16x1/2" Screw		2	2	2		
12	319704	Hi-Limit Mounting Bracket Only		1	1	1		
13	151000	6-32 Pal Nut		2	2	2		
14	151001	6-32x1/2" Screw		2	2	2		
15	130401	330 ⁰ Hi-Limit		1	1	1		

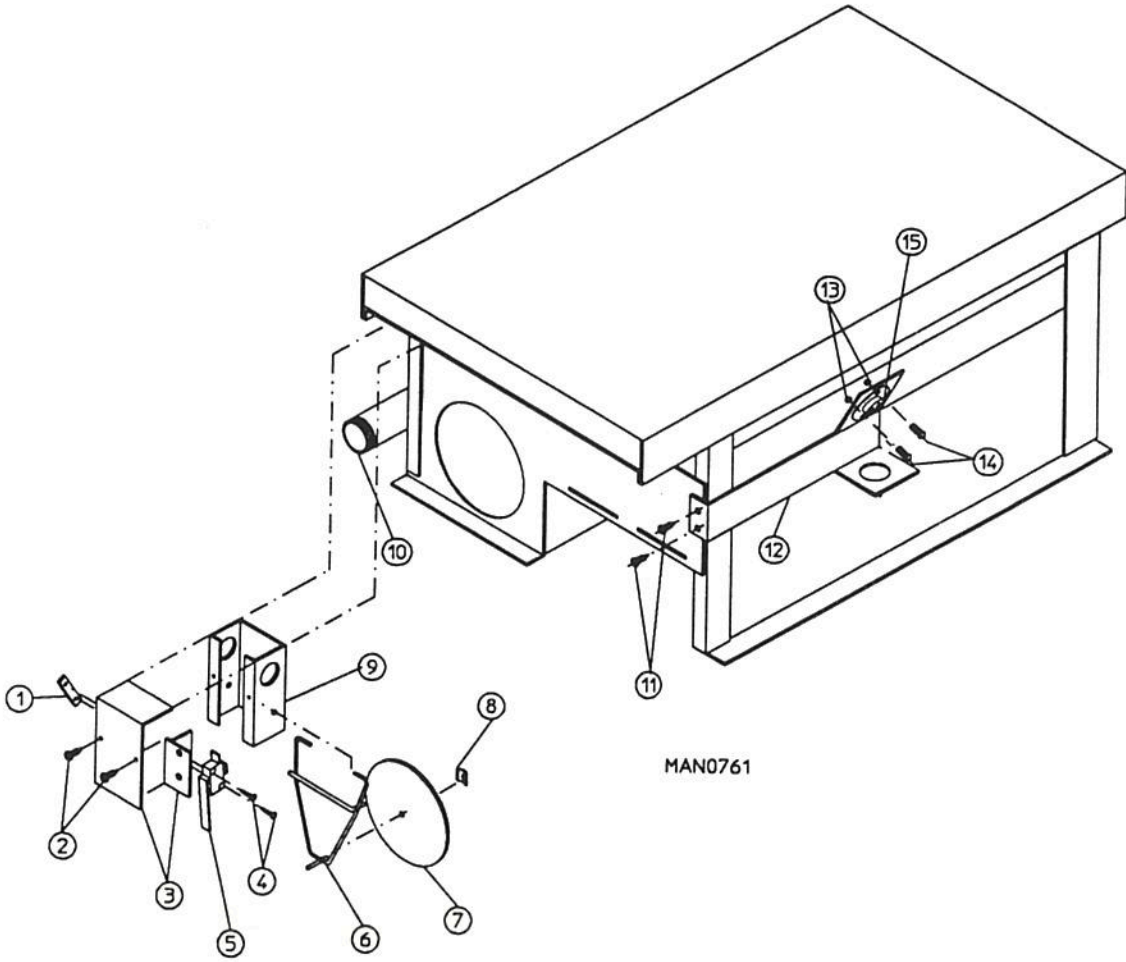

MAN0761

MAYTAG

Customer Service
240 Edwards St.
Cleveland, TN 37311